



**SNOW  
QUEEN  
TROPHY**  
FIS World Cup 2006 - Zagreb / Sljeme



# Official Team Invitation

ZAGREB - SLJEME  
CROATIA  
05.01.2006

LADIES NIGHT SLALOM

[info@snowqueentrophy.com](mailto:info@snowqueentrophy.com)  
[www.snowqueentrophy.com](http://www.snowqueentrophy.com)



*Jamnica*

**gorenje**

**Jutarnji** LIST



**CROATIA**





# OFFICIAL TEAM INVITATION TO THE FIS WORLD CUP "SNOW QUEEN TROPHY" 2006 ZAGREB - SLJEME

The Croatian Ski Association has the pleasure of inviting all National Ski Associations to attend the **2006 FIS Alpine Women's World Cup Event "Snow Queen Trophy"** which will be held on **Sljeme Ski Resort above Zagreb, Croatia on January 5, 2006.**

You will find all the important team-related information in this document.

## **ORGANISER:**

### **Croatian Ski Association**

Trg Krešimira Čosića 11  
HR-10000 Zagreb  
CROATIA

Phone: +385-1-3093 009  
Fax: +385-1-3093 016  
E-mail: [croski@croski.hr](mailto:croski@croski.hr)  
[info@snowqueentrophy.com](mailto:info@snowqueentrophy.com)  
Website: [www.croski.hr](http://www.croski.hr)  
[www.snowqueentrophy.com](http://www.snowqueentrophy.com)

## **CO-ORGANISER:**

City of Zagreb  
City Council  
Trg Stjepana Radića 1  
HR-10000 Zagreb  
CROATIA

## **ORGANISING COMMITTEE:**

President:	<i>Srećko Ferenčak</i>
Vice President:	<i>Marijan Maras</i>
Event Manager:	<i>Vedran Pavlek</i>
Secretary General:	<i>Damir Raos</i>
Secretary:	<i>Ana Marija Komparić</i>

## **JURY:**

Technical Delegate:	<i>Jaro Kalan (SLO)</i>
FIS Chief Race Director:	<i>Atle Skaardal (FIS)</i>
Chief of Race:	<i>Reno Fleiss (CRO)</i>

**ORGANISING COMMITTEE CONTACTS:**

Event Manager:	<i>Vedran Pavlek</i> Mobile phone: <i>+385-98-355 001</i> E-mail: <i><a href="mailto:pavlek@croski.hr">pavlek@croski.hr</a></i>
Secretary:	<i>Ana Marija Komparić</i> Mobile phone: <i>+385-98-333 012</i> E-mail: <i><a href="mailto:komparic@croski.hr">komparic@croski.hr</a></i>

**ENTRIES:**

**Preliminary entries** should be sent **by November 29, 2005**, stating the estimated number of team members expected to come (competitors, coaches, accompanying persons and service personnel).

**Final entries** with definitive names and arrival & departure dates must be sent on official FIS entry forms by **December 29, 2005**.

Please **fill out the enclosed rooming list** and send it together with the final entry by **December 29, 2005** at the latest.

We are kindly asking all teams to state the **exact date of arrival and departure in their entries.**

All entries can be sent by regular mail, e-mail or fax to the Organising Committee at the following address:

**Croatian Ski Association**  
attn. Ms. Ana Marija Komparić  
Trg Krešimira Čosića 11  
HR-10000 Zagreb  
Phone: *+385-1-3093 009*  
Fax: *+385-1-3093 016*  
E-mail: *[komparic@croski.hr](mailto:komparic@croski.hr) / [info@snowqueentrophy.com](mailto:info@snowqueentrophy.com)*

**ACCOMMODATION:**

**All teams, FIS officials, guests and media representatives** will be accommodated in the newly renovated and five-star **The Westin Zagreb Hotel** in downtown Zagreb.

**The Westin Zagreb Hotel\*\*\*\*\***  
Contact person: *Mr. Robert Šir*  
Kršnjavoga 1  
HR-10000 Zagreb  
Phone: *+385-1-4892 000*  
Fax: *+385-1-4892 091*  
E-mail: *[robert.sir@westin.com](mailto:robert.sir@westin.com)*

The following will be provided at the hotel:

- Welcome and Info Desk
- Accreditation Centre
- Main Race Office
- Team Captains' Meeting Room
- Main Press Centre
- Ski rooms
- all meals

Directions to the hotel and the ski resort are enclosed to this Invitation and can be found on the official race web site: [www.snowqueentrophy.com](http://www.snowqueentrophy.com)

Enclosed is also a **hotel lobby floor plan**, including **all conference rooms**.

In case the **departure date is January 5, 2006**, the Organising Committee **guarantees that the teams will have the right for late check out** after the race is finished.

If the **departure date is scheduled for January 5, 2006**, and the teams, after the race, **decide to stay until January 6, 2006**, the Organising Committee will **guarantee them the accommodation**.

The Organising Committee **guarantees that the accommodation costs will be settled on the basis of free three-night accommodation and total free number of nights per team**, regardless of the real dates of arrival and departure.

In case the **accommodation is booked until January 6, 2006**, and the team leaves earlier, the Organising Committee will have to **calculate the accommodation costs on the basis of departure on January 6, 2006 as booked**, regardless of the real date of departure.

#### **WELCOME AND INFO DESK:**

The Welcome and Info desk will be located opposite to the main entrance to The Westin Zagreb Hotel. Teams can get all necessary information and directions there.

#### **HOTEL REGISTRATION:**

All teams must register at the front desk located in the lobby of the Westin Zagreb Hotel. The team captain of each team will have to provide a **credit card to guarantee all extra charges for all rooms of his/her team**.

**Each person must fill out and sign a separate registration form.**

At the time of registration **you will have to exchange the hotel parking ticket for a permanent one.**

#### **TEAM MEALS:**

Team meals will be provided in the **Kaptol Restaurant** of The Westin Zagreb Hotel located in the lobby.

The meal schedule will be compatible with the training and competition schedule.

In the Kaptol Restaurant, **complimentary non-alcoholic drinks and beer** will be provided with every meal.

**On the race day, team hospitality** with food and beverages will be provided at the **Vidikovac Restaurant** located at the top of Sljeme Ski Resort, just below the TV tower.

In the **warm-up tent** located next to the start, light snacks, fruits and beverages will be provided.

### **ACCREDITATION OFFICE:**

The Accreditation office for teams is located in **Zrinjevac hall** in the lobby of The Westin Zagreb Hotel.

#### **Accreditation office opening hours:**

Tuesday, January 3	08.00 - 24.00
Wednesday, January 4	08.00 - 24.00
Thursday, January 5	08.00 - 18.00

### **RACE OFFICE:**

The Race office will be located in **Maksimir hall** at The Westin Zagreb Hotel and will be open from January 3, 2006 until January 6, 2006.

Phone:	+385-1-3093 009
Fax:	+385-1-3093 016
E-mail:	<a href="mailto:info@snowqueentrophy.com">info@snowqueentrophy.com</a> <a href="mailto:klinarmed@croski.hr">klinarmed@croski.hr</a> <a href="mailto:croski@croski.hr">croski@croski.hr</a>

Race office Secretary: *Agata Klinar Medaković*

#### **Race office opening hours:**

Tuesday, January 3	12.00 - 24.00
Wednesday, January 4	08.00 - 24.00
Thursday, January 5	08.00 - 12.00
Friday, January 6	08.00 - 12.00

During the **competition day**, the Race office will also be located **at the finish area of the Sljeme Ski Resort** in the **Jezero Restaurant** and open from **12.00 - 21.00**

### **PARKING:**

At the hotel: *- outside, in front of the hotel*  
*- in the garage - for servicemen only*

At the ski resort: *- near the Hotel Tomislavov dom, only for team vehicles with parking permits*



## **PARKING PERMITS:**

Parking permits for **January 4, 2006**, will be delivered to the team captains **at the time of accreditation**.

Parking permits for **January 5, 2006**, will be delivered to the team captains **at the team captains meeting**.

Please request **a minimum number of parking permits** due to the very limited parking space at the top of Sljeme Ski Resort.

## **TRANSPORTATION:**

**On the training and race days, access to the road to Sljeme** will only be allowed for teams **with parking permits**.

For easier and faster transit through the city centre, **on the training and race day** there will be a **convoy organized for all teams, leaving from The Westin Zagreb Hotel as follows:**

- **January 4, 2006: at 08.45**
- **January 5, 2006: at 12.15**

Please be ready **15 minutes prior to departure**. You may leave earlier or later to Sljeme by your own arrangement, responsibility and parking permit but you may risk heavy traffic in the city centre and heavy spectators' bus traffic on the road to Sljeme on the race day, traffic which will be stopped for 15 minutes for the team convoy.

Directions to the ski resort and hotel will be marked on the roads and are shown on the enclosed maps.

## **SKI WAXING ROOMS:**

Every team will have a separate Ski waxing room for storing, preparation and waxing of skis at their disposal.

The Ski waxing rooms are located in the **garage of The Westin Zagreb Hotel** and will be open from January, 3, 2006 until January, 6, 2006.

The Ski rooms will have lockers and security 24 hours a day.

The person in charge of the ski rooms is **Mr. Željko Čvorak (mobile phone: +385-98-333 015)**.

Enclosed is a map of the ski rooms.

## **FREE SKIING, OFFICIAL TRAINING AND WARM UP:**

**Free skiing on the Race course** will be held on **January 4 from 10.00 - 10.30**, snow conditions permitting.

**Official training** will be held on **January 4 on the Zeleni spust course from 10.30 - 12.30**, snow conditions permitting.

**Warm up** will be held on **January 5 on the Zeleni spust course from 14.00 - 15.30**, snow conditions permitting.

The Organising Committee will also provide **Giant slalom training on January 6 from 09.00-11.00 and Slalom training from 11.00-13.00 on Crveni spust**, snow conditions permitting.

### **PHYSICAL TRAINING:**

A **gym** for stretching, fitness and physical training is also **located at The Westin Zagreb Hotel, on the first floor.**

The gym will be open **only for competitors on January 4, 2006 from 15.00 until 19.00.**

All hotel guests can use the hotel swimming pool on the first floor.

### **TEAM CAPTAINS MEETING:**

The Team captains' meeting will be held on **January 4, 2006 at 17.00 in Crystal hall (2/3)** in The Westin Zagreb Hotel.

### **PUBLIC DRAW:**

Public draw for the best 15 competitors will be held on **January 4, 2006 at 19.00 at the Trg bana J. Jelačića (main square in Zagreb).**

**Shuttles** for competitors will depart from The Westin Zagreb Hotel to the main square **at 18.30** and will return to hotel immediately after the public draw.

### **TECHNICAL INFORMATION ABOUT THE RACE COURSE:**

Course name:	<i>Crveni spust</i>
Start:	<i>985 m</i>
Finish:	<i>785 m</i>
Vertical drop:	<i>200 m</i>
FIS homologation No.:	<i>7669/12/04</i>

### **RULES:**

- *FIS Ski World Cup „Snow Queen Trophy“ will be held in accordance with the Rules for the Alpine FIS Ski World Cup 2005/06 and the FIS ICR Rules*
- *Number of competitors per nation is determined according to the Rules for the Alpine FIS Ski World Cup 2005/06 and FIS World Cup Quotas*
- *Entry to the race course is allowed only with the course accreditation issued by the FIS Chief Race Director at the Team captains' meeting*
- *Every team member must at all times wear his/her accreditation since access to certain zones without accreditations will not be allowed.*

### **INSURANCE:**

Competitors compete on their own liability.

The National Ski Associations are responsible for adequate insurance coverage for all their racers (Art. 204.2 of the FIS ICR Rules).

### **PAYMENT FOR ACCOMMODATION EXPENSES:**

After the Team captains' meeting, **team captains will receive a voucher with the maximum number of the nights** according to the Rules for the Alpine FIS Ski World Cup 2005/06.

Team captains will **present this voucher to the front desk** at check out and will pay **all extra nights for additional officials** (if any) **directly to the hotel** at the **rate of 100 CHF per person per night for full board**, in accordance with the Rules for the Alpine FIS Ski World Cup 2005/06.

Team captains are **responsible for all team extra charges** (telephone, minibar, pay TV, etc.)

### **TRAVEL EXPENSES:**

Travel Expenses will be paid in accordance to the Rules for the Alpine FIS Ski World Cup 2005/06 and they will be paid **in cash on the race day in the Race Office** located in the **Jezero Restaurant at the finish area from 16.45 until 21.00**.

In **addition**, travel expenses may be picked up in the **main Race Office** located in the **Maksimir hall at The Westin Zagreb Hotel on January 6, 2006 from 08.00 - 12.00**.

### **PRIZE MONEY:**

Prize money will be paid in accordance to the Rules for the Alpine FIS Ski World Cup 2005/06.

It will be **paid in checks on the race day in the Race Office** located in the **Jezero Restaurant at the finish area from 19.30 - 21.00**.

In **addition**, prize money may be picked up in the **main Race Office** located in the **Maksimir hall at The Westin Zagreb Hotel on January 6, 2006 from 08.00 - 12.00**.

**The total prize money fund** for the FIS World Cup "Snow Queen Trophy" 2006 is **165.000 EUR** and will be distributed as follows:

1st place	60.000 EUR	16th place	1.700 EUR
2nd place	30.000 EUR	17th place	1.650 EUR
3rd place	15.000 EUR	18th place	1.600 EUR
4th place	8.000 EUR	19th place	1.550 EUR
5th place	6.000 EUR	20th place	1.500 EUR
6th place	5.000 EUR	21st place	1.450 EUR
7th place	4.000 EUR	22nd place	1.400 EUR
8th place	3.000 EUR	23rd place	1.350 EUR
9th place	2.500 EUR	24th place	1.300 EUR
10th place	2.000 EUR	25th place	1.250 EUR
11th place	1.950 EUR	26th place	1.200 EUR
12th place	1.900 EUR	27th place	1.150 EUR
13th place	1.850 EUR	28th place	1.100 EUR
14th place	1.800 EUR	29th place	1.050 EUR
15th place	1.750 EUR	30th place	1.000 EUR

The Croatian State Tax will be deducted from prize money in accordance with the Croatian Tax Law.



**PRESS CENTRE & MEDIA INFO:**

The **Main press centre** will be located at the **Crystal hall (1/3)** in The Westin Zagreb Hotel.

The **Sub press centre** on the **race day** will be located at the top of Sljeme Ski Resort in the newly renovated three-star **Hotel Tomislavov dom**.

**Media accreditation and accommodation forms**, as well as all necessary media information can be found on the official web site: [www.snowqueentrophy.com](http://www.snowqueentrophy.com)

**Shuttle transport for all media representatives** from The Westin Zagreb Hotel to the Hotel Tomislavov dom (Sub press centre) will be organized.

From there, the media will be able to **reach the finish area by a chairlift**.

It will not be possible for media representatives to drive their own cars to the site due to the limited parking space and the special transport system, TV vehicles will be exempted from this restriction.

**TV vehicles** will get **drop off parking permits for the finish area** and **parking on Krumpirište** (1,3 km from the finish area) from where shuttle transport will be organized.

**Main press centre opening hours:**

Tuesday, January 3	12.00 - 22.00
Wednesday, January 4	08.00 - 24.00
Thursday, January 5	08.00 - 24.00
Friday, January 6	08.00 - 14.00

**Sub press centre opening hours:**

Thursday, January 5	10.00 - 24.00
---------------------	---------------

Chief of Press:	<i>Kristina Laco</i>
Coordinator for Photographers:	<i>Renčo Kosinožić</i>
Press coordinator in the finish area:	<i>Ozren Müller</i>

**OTHER INFORMATION:**

All the latest news about the FIS World Cup "Snow Queen Trophy" 2006 including all maps and other information, can be found on the official website: [www.snowqueentrophy.com](http://www.snowqueentrophy.com) from November 15, 2005.

We wish you all a successful season and safe trip to Zagreb.  
See you in Zagreb.

CROATIAN SKI ASSOCIATION  
Organising Committee FIS World Cup "Snow Queen Trophy" 2006



Srećko Ferenčak  
President



Vedran Pavlek  
Event Manager

## OFFICIAL PROGRAMME:

- Tuesday, Jan. 3:**
- 08.00 - 24.00 Accreditation office in The Westin Zagreb Hotel open
  - 12.00 - 22.00 Press centre in The Westin Zagreb Hotel open
  - arrival of the teams in the afternoon and evening hours
- Wednesday, Jan. 4:**
- 08.00 - 24.00 Accreditation office open
  - 08.00 - 24.00 Press centre in The Westin Zagreb Hotel open
  - 08.45 Teams convoy departure from The Westin Zagreb Hotel
  - 10.00 - 10.30 Free skiing on the Race course
  - 10.30 Course setting
  - 10.30 - 12.30 Training on the Zelene spust course
  - 17.00 Team captains' meeting in The Westin Zagreb Hotel
  - 18.00 - 22.00 "World Cup Party" for the public at the Trg bana J. Jelačića
  - 18.30 Shuttle for the public draw leaves from The Westin Zagreb Hotel
  - 19.00 Public draw at the Trg bana J. Jelačića (main square in Zagreb)
  - 20.00 - 03.00 "World Cup Gala Party" for teams, media, sponsors and guests in the "Gradska kavana" at the Trg bana J. Jelačića
- Thursday, Jan. 5:**
- 08.00 - 18.00 Accreditation office open
  - 08.00 - 24.00 Press centre in The Westin Zagreb Hotel open
  - 10.00 - 24.00 Sub press centre in the Hotel Tomislavov dom on Sljeme open
  - 12.15 Teams and media convoy departure from The Westin Zagreb Hotel
  - 13.30 - 14.00 Course inspection 1<sup>st</sup> run
  - 14.00 - 15.30 Warm up on Zelene spust course
  - 15.15 Start 1<sup>st</sup> run
  - 17.00 - 17.30 Course inspection 2<sup>nd</sup> run
  - 18.15 Start 2<sup>nd</sup> run
  - 19.15 Awards ceremony in the finish area
  - 20.15 Press conference in the Sub press centre
  - 10.00 - 22.00 "World Cup Show" for the public on Sljeme - Krumpirište
  - 14.00 - 22.00 "World Cup Show" for the public at the Trg bana J. Jelačića in Zagreb
- Friday, Jan. 6:**
- 09.00 - 11.00 GS training possible on Crveni spust
  - 11.00 - 13.00 SL training possible on Crveni spust
  - 08.00 - 14.00 Press centre in The Westin Zagreb Hotel open
  - Teams' departure in the morning and afternoon hours

The Organising Committee reserves the right to change the Programme!

# THE WESTIN ZAGREB HOTEL LOBBY LEVEL FLOOR PLAN

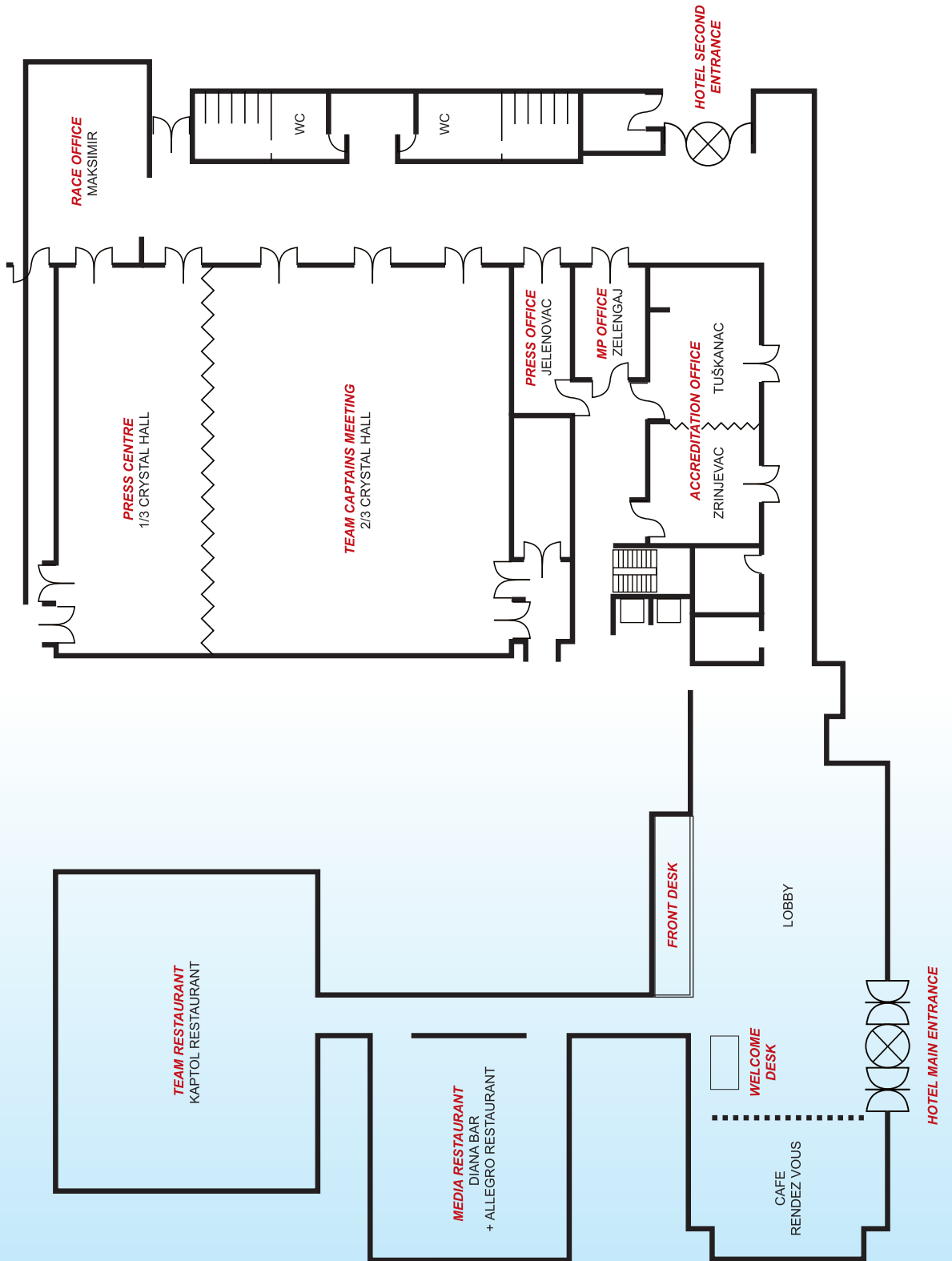

SNOW  
QUEEN  
TROPHY

# SKI WAXING ROOMS IN THE WESTIN ZAGREB HOTEL GARAGE

SNOW  
QUEEN  
TROPHY

