



SkiWorldCup

I-39030 San Vigilio di Marebbe (BZ)  
Str. Plan de Corones 38

+39 0474 431 014  
www.skiworldcup-kronplatz.com

# SARS-CoV-2 Health & Safety Protocol

**26|01|21**  
**WOMEN'S GS**  
**ERTA · KRONPLATZ**





# HEALTH & SAFETY PROTOCOLS

The following protocols were established by the **Organizing Committee** for the Women's Alpine Skiing World Cup Kronplatz, working closely with the local health authorities!

- ▣ Limit as much physical contact and interaction as possible by establishing sanitary bubbles
- ▣ A sealed off race area with very strict health and safety protocols
- ▣ Adhere to physical distancing protocols and protective measures everywhere
- ▣ Wearing a Mask is required at all times, in every area (indoors and outside)



## General Info

This year only people with accreditation will have access to the event. After the registration in the EventBuilder System with full name, phone number and sanitary bubble affiliation

### RED BUBBLE

Athletes, Trainers, Team Support Staff, Equipment Service, SRS, FIS, Timing and Data Service

Negativ Covid-19 Test before the Event to be uploaded on the FIS Passport & a rapid antigen Test on Site before Accreditation

### YELLOW BUBBLE

Journalist, Photographer, TV INFRONT Team

Negativ Covid-19 Test before the Event to be Uploaded on the FIS Passport & a rapid antigen Test on Site before Accreditation

### BLUE BUBBLE

Local Organizing Committee, Officials, Volunteers, Slippers, Workforce

Rapid antigen Test bevor Accreditation



# FIS PASSPORT

- People from the Red & Yellow Bubble have to register on the FIS PASSPORT application (<https://fispasport.fis-ski.com/fis/>)
- After you have confirmed your participation for the event,
  - add Covid-19 Test results (will also be saved in Test history)
  - fill in Whereabouts for defined period (14 days)
- A pre-event health questionnaire will be sent 6 days prior to the race (+daily health check)
- Your status will be reviewed by the OC

The results of the negative Covid-19 Test (PCR- or rapid antigen Test) carried out (conducted within 72 hours of arrival at the venue) and the completed questionnaire as well as the whereabouts must be published in the FIS PASSPORT within Saturday 23.01.2021



## General Info

The whole event will be equipped with the necessary safety devices (hand sanitiser dispenser, information signage...) according to the current legislation.  
The accesses will be under surveillance by security.

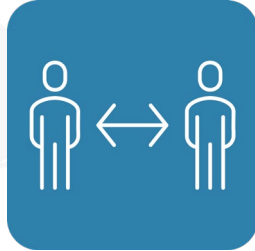



# General Behaviour

- ▣ If you have tested positive for Covid-19 and you still have no negative test result, please do **not travel to the event venue!** (the local health authorities make no distinction about a low or high CT-Value)  
If you feel sick or have any Covid-19 symptoms, do not travel to the event venue!
- ▣ **Hygiene**
  - Wash your hands regularly
  - Use the provided disinfection dispensers
  - Avoid handshaking
- ▣ Wearing a face mask is mandatory in all areas
- ▣ **Avoid Contacts**
  - Direct contacts should be limited as much as possible
  - Maximise distance between you and people from different “bubbles”
- ▣ **After the Race:** if any known Covid-19 symptoms appear contact our Health Coordinator



## Reporting of sickness during the event

- If you feel sick or have any Covid-19 symptoms, contact the OC & FIS designated contact person immediately
- Isolate yourself at the venue/in the hotel
- A rapid antigen Test will be conducted
- Isolation until the test result
- In case of a positive test result further measures and tests will be coordinated by FIS and the local health authorities



# SARS-CoV-2 Testing Procedure

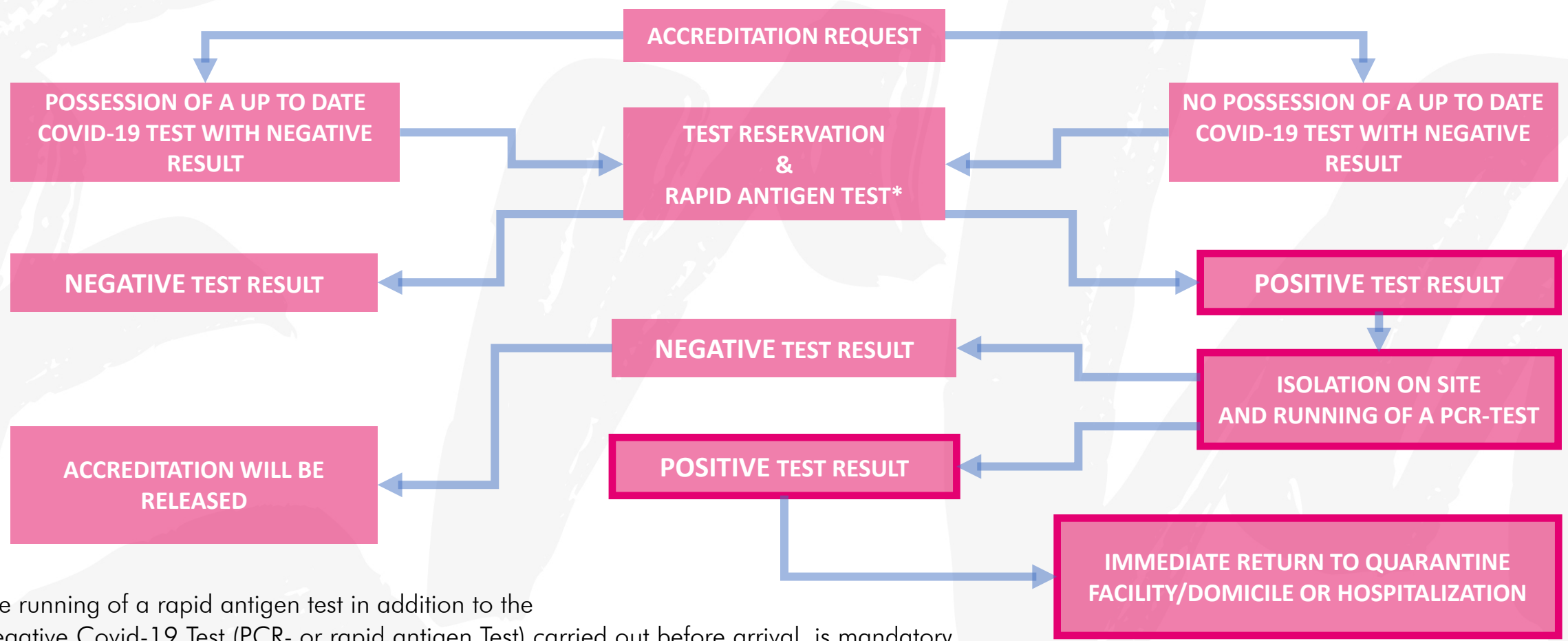

\*The running of a rapid antigen test in addition to the Negative Covid-19 Test (PCR- or rapid antigen Test) carried out before arrival, is mandatory





# SARS-CoV-2 Test Center

- ▮ The “**Test Center**” is located at Str. Plan de Coronas 30 – School Area/Gym I-39030 San Vigilio di Marebbe (BZ) (map on slide 22)
  
- ▮ **Opening Hours**
  - Saturday, January 23<sup>rd</sup> from 09:00 to 12:00 and from 13:30 to 18:00
  - Sunday, January 24<sup>th</sup> from 15:30 to 22:00
  - Monday, January 25<sup>th</sup> from 08:00 to 12:00 and from 14:30 to 18:30
  - Tuesday, January 26<sup>th</sup> from 08:00 to 11:00
  
- ▮ On-site antigen testing arranged by the OC available **only upon online reservation through the EventBuilder System**



# SARS-CoV-2 Test Center

- Costs for own testing done before arrival at the event are carried by the single person or responsible group
  - Cost for rapid antigen test: € 25,00.- per unit
  - Cost for PCR test: € 75,00.- per unit
- Outcome waiting time: approx. 15-30 minutes for rapid antigen tests results ; approx. 6 hours for PCR-Test results
- Costs for on-site rapid antigen tests, arranged by the Organizer and national health authorities, are carried by the Organizing Committee
- The testing service will be organized by the local health authorities in collaboration with the Croce Bianca Alto Adige. The contact person will be Dr. Franzoni who will verify all tests and issue the authorization to precede to the accreditation



# Accreditation

- The Accreditation Office is located at Str. Plan de Coronas 30 – School Area/Gym I-39030 San Vigilio di Marebbe (BZ)
- Access to the Accreditation Office only with a confirmed negative antigen test result (SMS)
- Only one person per team/group lines up and collects all accreditations
- Keep distance to others as much as possible
- Wear a face mask in- and outside the Accreditation Office
- Respect ways/paths and signage at the venue



## At the Venue

- ▣ Reduce time at the venue to a minimum
- ▣ all areas will be organized to limit the flow of people as much as possible
- ▣ Wear a face mask
- ▣ Keep distance to others as much as possible
- ▣ All areas will be delimited using fences to avoid contact between various groups, avoid unauthorized access and keep entries and exits separated
- ▣ Respect ways/paths and signage at the venue
- ▣ „Act as you want others to act“



## Meetings

- ▣ Meetings will be reduced to a minimum
- ▣ Meetings are held in the respect of the Local Corona protocols and the appropriate distance measures
- ▣ Wear a face mask
- ▣ Team Captains Meeting
  - Will be held as livestream
  - The livestream will be accessible for media
  - Bib Draw at Team Captains Meeting
- ▣ Press Conference after the Race – TBC



# Accommodations

Hotels will follow the National Health Regulations and try to adjust to the FIS guidelines as well

- ▣ Allocation/booking of accommodation for teams only via OC
- ▣ Check-in at allocated hotel only after you've picked up the accreditation
- ▣ Try to stay separated from other hotel guests
- ▣ Usage of hotel gym, pools, saunas only if reserved exclusively for athletes
- ▣ Review the circulation flow and distancing policy in common spaces
- ▣ No training in hallways
- ▣ Respect the hotel rules and general rules of hygiene



## Travel, Transport and Parking

- ▮ Organize your own transport/transfer from hotel to the venue
- ▮ Reserved Parking area at the Skitrans Bronta Mountain Station for Teams; access only with specific pass handed out when collecting accreditation
- ▮ Separated access to the gondolas for red-, yellow- and blue bubble



## Team Hospitality

- Team Hospitality at the Restaurant Col dl'Ancona will be available Tuesday 26<sup>th</sup> January
- Access only for Teams with specific pass handed out by FIS
- Keep the designated distance
- Wearing a face mask is mandatory in all areas except when sitting at the table for meal
- No meals in the finish area





# Price Giving Ceremony

- ▮ The official prize giving ceremony will be held in the finish area immediately after the race
- ▮ Wear a face mask at all times
- ▮ Keep the designated distance
- ▮ Respect the general rules of hygiene
- ▮ Trophies will be placed on the podium



## Media

- ▣ Face masks must be worn in all in- and outdoor areas, on- and off course
- ▣ Social distancing should be obeyed, movements should be limited
- ▣ No direct access to athletes; at least 2 meter distance in competition areas
- ▣ Interviews must be conducted in the finish area
- ▣ Photographers will not be able to enter the finish area to take photos of the ceremony. Instead the podiums will be placed in such a way that photos of the ceremony are possible from the photo stands
- ▣ Compliance with the FIS guidelines



# Contacts

## ▮ Main Contact for general enquiries

Audi FIS Ski World Cup KRONPLATZ  
Organizing Committee AL Plan Events  
Str. Plan de Coronas 36  
I-39030 San Vigilio di Marebbe (BZ)  
+39 0474 431 014  
[info@skiworldcup-kronplatz.com](mailto:info@skiworldcup-kronplatz.com)

## ▮ Contact for on-site test related enquiries and in case of symptoms Phone: +39 334 7206929

## ▮ Health Coordinator Dr. Patrick Franzoni and Lukas Innerhofer Email: [patrick.franzoni@sabes.it](mailto:patrick.franzoni@sabes.it)



## Travel Restrictions

Latest information's regarding travel restrictions to and from Italy can be found at the following links:

<http://www.salute.gov.it/portale/nuovocoronavirus/dettaglioContenutiNuovoCoronavirus.jsp?lingua=english&id=5412&area=nuovoCoronavirus&menu=vuoto>

<https://infocovid.viaggiasesicuri.it/>

# Annex 1 – Map of San Vigilio di Marebbe

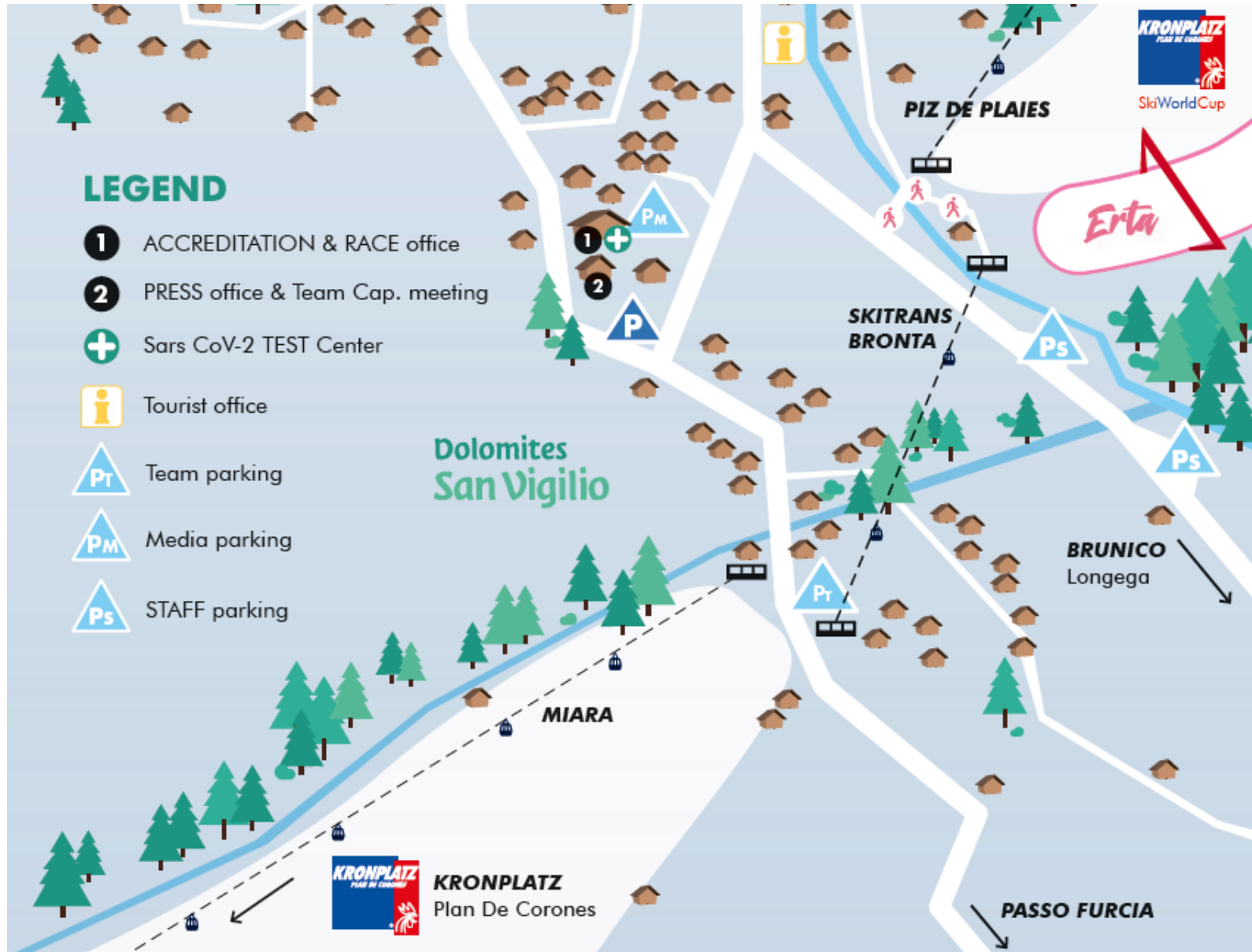

# Annex 2 – Map Testing Center/Accreditation Office



# Annex 2.1 – Map Testing Center/Accreditation Office

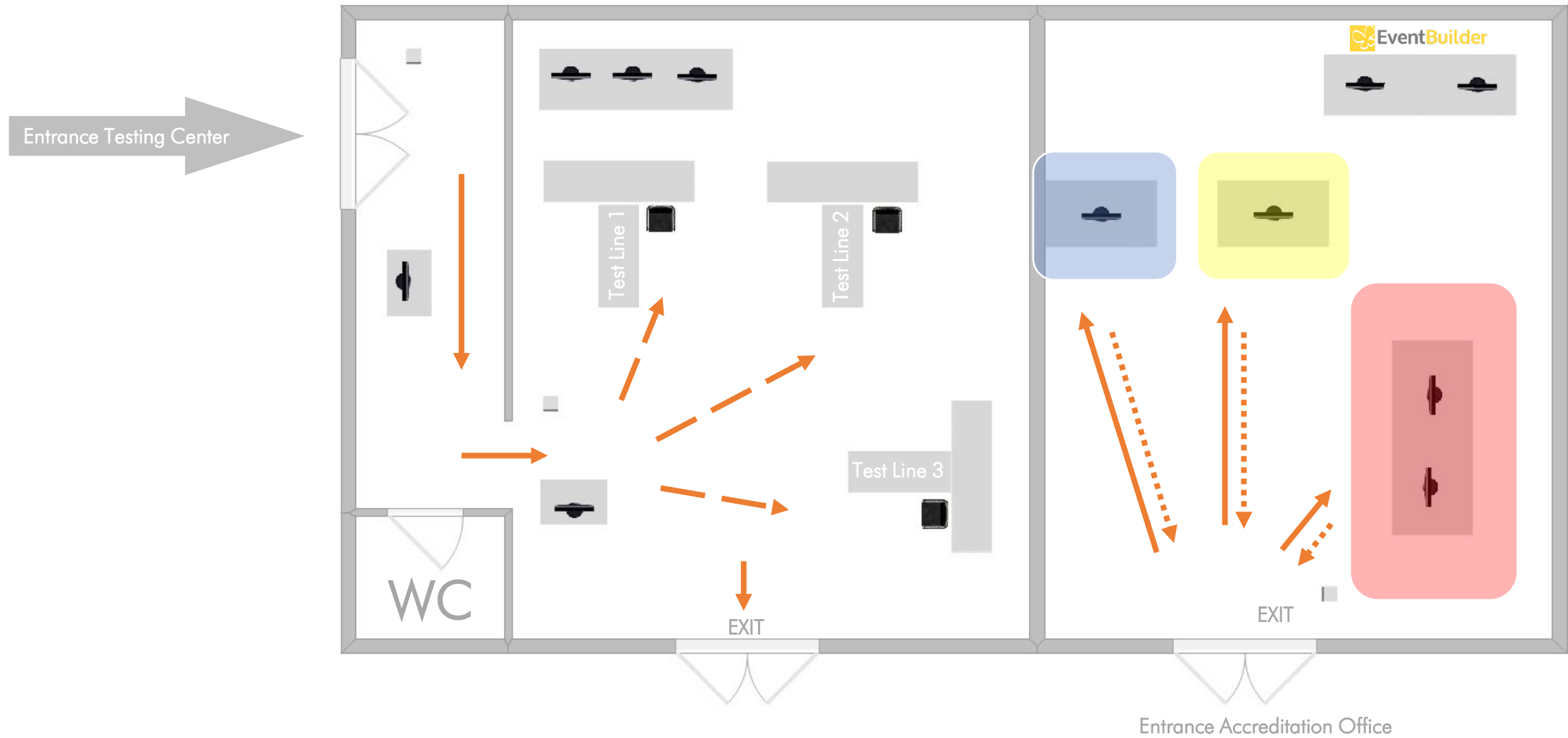

# Annex 3 – Start Area

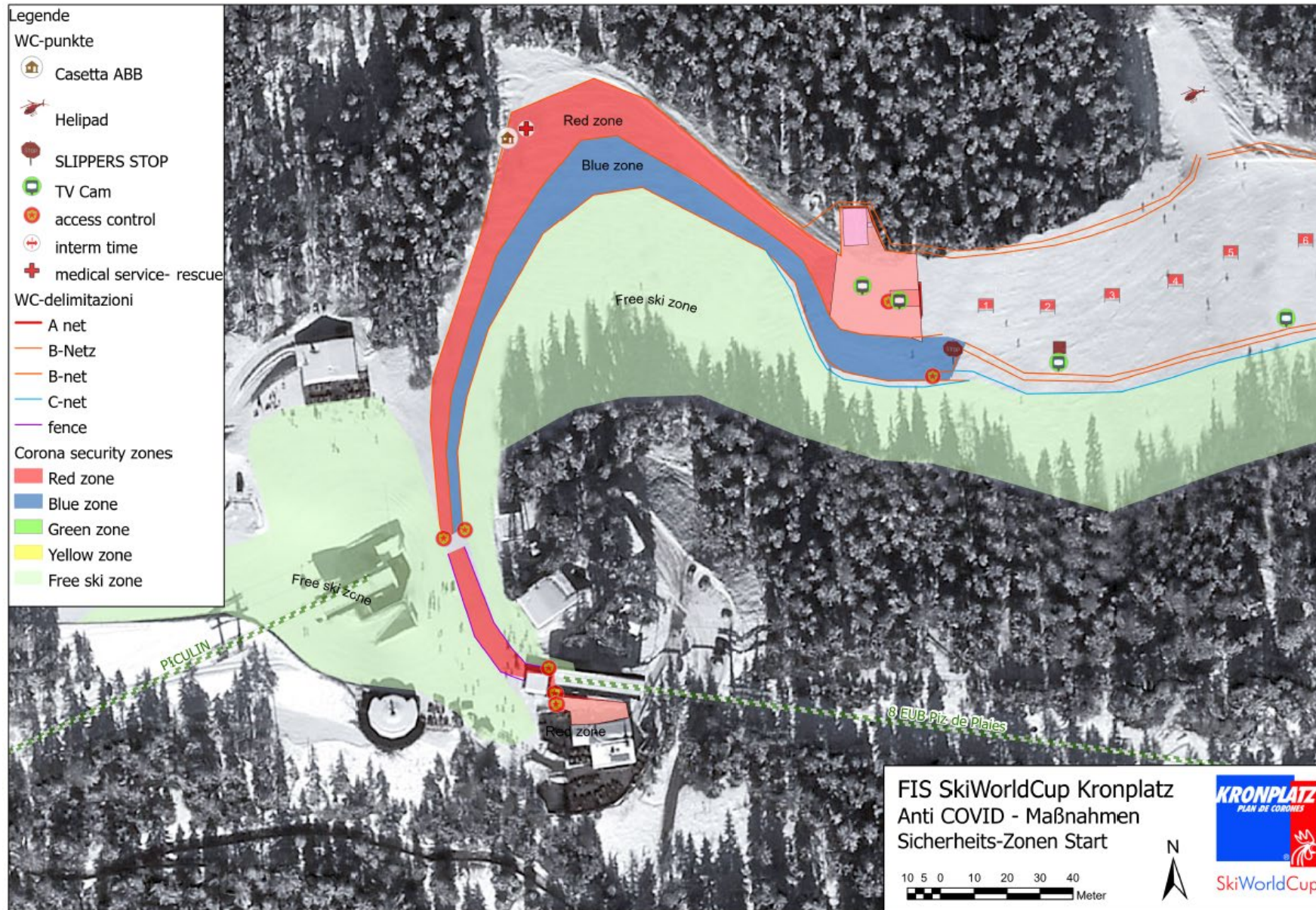



# Annex 4 – Finish Area

