



COVID-19 PREVENTION GUIDELINES AND TEST PROTOCOL

AUDI FIS SKI WORLD CUP "SNOW QUEEN TROPHY" 2021
ZAGREB – SLJEME

1. INTRODUCTION	3		
2. CURRENT COVID-19 SITUATION IN CROATIA	4		
3. ENTRY TO CROATIA	4		
4. GENERAL PRINCIPLES AND RULES	5		
5. DIFFERENT SNOWFLAKES (BUBBLES) / PARTICIPATING GROUPS	6		
6. COVID-19 TEST PROTOCOL	8		
7. FIS COVID-19 PASSPORT	9		
8. HEALTH AND SAFETY PROTOCOL BY ZONES	10		
8.1. Arrival to Zagreb	10		
8.2. Airport arrival	10		
8.3. Airport departure	10		
8.4. Accreditation	10		
8.5. Transportation	11		
8.6. Accommodation	12		
8.6.1. Team hotel – The Westin Zagreb Hotel	12		
8.6.2. Media hotel – Sheraton Zagreb Hotel	13		
8.6.3. Organising Committee hotel – Hotel Tomislavov dom	13		
8.6.4. Organising Committee hotel – Apt. Snježna kraljica	14		
8.7. Team Captains' Meeting	14		
8.8. Main Race office – The Westin Zagreb Hotel	14		
8.9. Parking	15		
8.10. Gym	15		
8.11. Public draw & side events	15		
8.12. New gondola (cable car)	15		
8.13. The Race Venue	15		
8.13.1. Top of Sljeme	16		
8.13.2. Team Hospitality	16		
8.13.3. Ski chairlift	16		
8.13.4. Start area	16		
8.13.5. Start bib's distribution	16		
8.13.6. Race course	17		
8.13.7. Timing room	17		
8.13.8. Finish area corridors:	17		
8.13.8.1. Team 1 and 2 finish zones	17		
8.13.8.2. Press and Radio zone	17		
		8.13.8.3. Live TV box	17
		8.13.8.4. TV ENG area	17
		8.13.8.5. FIS material control tent	17
		8.13.8.6. Medical team area	17
		8.13.8.7. Award Ceremony	17
		8.13.9. Race office	18
		8.13.10. Ski preparation area	18
		8.13.11. Anti-doping control	18
		8.13.12. Medical facilities	18
		8.14. Media & Broadcasters facilities	18
		8.14.1. Press Office	18
		8.14.2. Press Conference	18
		8.14.3. Press Centre and Photo Corner	18
		8.14.4. Host Broadcaster TV Truck	19
		8.14.5. Media Hospitality	19
		8.15. Organiser Hospitality	19
		9. ONSITE COVID-19 TESTING FACILITIES INCLUDING MAPS	20
		9.1. The Westin Zagreb Hotel	20
		9.2. Croatian Institute of Public Health	21
		9.3. “Dr. Andrija Štampar” Teaching Institute of Public Health	22
		9.4. Antigen rapid tests	23
		9.4.1. Polyclinic LabPlus Zagreb	23
		9.4.2. Specialty Hospital “Sv. Katarina” Zagreb	24
		10. COVID-19 PROTOCOL IN CASE OF SYMPTOMS	25
		11. FIS COVID-19 COMMUNICATION POLICY	25
		12. MAPS	26
		12.1. Map of The Westin Zagreb Hotel	27
		12.2. Map of Ski rooms in The Westin Zagreb Hotel	28
		12.3. Map of Sheraton Zagreb Hotel	29
		12.4. Map of Top of Sljeme	30
		12.5. Map of Start area	31
		12.6. Map of Race course and corridors	32
		12.7. Map of Finish area	33
		12.8. Map of Finish area – detail	34
		12.9. Map of Press centre	35



1. INTRODUCTION

The Audi FIS Ski World Cup in Zagreb/Sljeme will take place on January 3 and 6, 2021, due to the current COVID-19 global pandemic, with enhanced safety and health measures.

This document is aimed to provide information and a guideline to all participants' groups, International Ski Federation-FIS, national and local health authorities, in order to deliver a safe event.

Measures in this document are to be considered subject to change and will be updated regularly with the epidemic situation in Croatia. This document complies with the national and local rules valid on the date highlighted on the front page of this Protocol. The Organiser reserves the right to make necessary changes, which will be announced to all participating groups immediately.

The FIS World Cup Testing Protocol defines the procedures, requirements, roles and responsibilities for the persons who are an integral part of carrying out FIS World Cup events. Everyone participating (accredited groups) is expected to follow the above mentioned to the best extent possible in order to minimise any risk of Covid-19 transmission.

COVID-19 Prevention Guidelines and Test Protocol are the primary guidelines from the event organisers' side and subject to national authorities and FIS approval. Due to the nature of the organising venue, some specific rules and guidelines are implemented for the event. These are documented in the following sections.

We kindly ask you to forward these Guidelines and Test Protocol to: for teams - all team members (athletes, coaches, servicemen, staff, NSA officials, etc.) registering for the event via the FIS Online entry platform; for media - all interested media representatives in this event requesting an accreditation, and for Organiser - all organising staff.

By registering for this event and picking up the accreditation, each accredited person fully agrees with and accepts the content of these Guidelines and Test Protocol for the Audi FIS Ski World Cup "Snow Queen Trophy" Zagreb/Sljeme 2021 races.

2. CURRENT COVID-19 SITUATION IN CROATIA

Like in most of Europe, the country has seen an increase in new infections in the last few months.

From November 28 until December 21, the Civil Protection Headquarters of the Republic of Croatia announced new measures including:

- Sporting events only for top athletes will be held without spectators,
- Public events and gatherings limited to 25 people,
- Individuals must maintain at least 2 meters of social distance indoors and at least 1.5 meters outdoors,
- Protective masks must be worn in all indoor areas and outdoor areas where it is not possible to maintain 1.5 meters of social distance,
- Nightclubs, casinos, restaurants, cafes, bars, and gaming arcades will be closed,
- A notice specifying the maximum number of people who may be in a facility must be prominently displayed,
- An obligation for stores to display a notice of the maximum number of customers allowed to enter,
- Ban on alcohol sales from 10 p.m. – 6 a.m.,
- Other gatherings (religious, ceremonies, cinemas, theatres, etc.) must allow at least four square meters of space per person.

You can find current information about COVID-19 on the following link:

www.koronavirus.hr

3. ENTRY TO CROATIA

On November 30, 2020, the Civil Protection Headquarters of the Republic of Croatia issued a Decision **temporarily prohibiting, i.e. restricting the crossing of persons across all border-crossing points of the Republic of Croatia in order to protect the population of the Republic of Croatia** from the COVID-19. However, in accordance with the guidelines of the competent authorities, the following exceptions have been made:

- for **EU/EEA citizens, no PCR test is required for business trips** (such as the Audi FIS Ski World Cup in Zagreb), **including press**;
- for **citizens of third countries, a negative PCR test result** for SARS-CoV-2 **not older than 48 hours** must be presented upon entering the Republic of Croatia **or a PCR test for SARS-CoV-2 has to be done immediately** upon entrance in the Republic of Croatia, with the mandatory self-isolation until recipient of a negative test result.

For smoother entrance to the Republic of Croatia, **it is advised to all persons entering the Republic of Croatia to fill out the Announcement in advance at Enter Croatia on the link entercroatia.mup.hr/**

This regulation is currently valid until January 15, 2021.

For actual regulations and information regarding the conditions of entry into the Republic of Croatia, considering temporary bans, i.e. restrictions in place to prevent the spread of COVID-19, please check the following web pages before your travel to Zagreb: mup.gov.hr/uzg-covid/english/286212 and www.koronavirus.hr/latest-news/recommendations-and-instructions-for-crossing-the-state-border/736.

When staying in the Republic of Croatia, all passengers, regardless of their citizenship and country from which they are arriving, are obliged to follow the general and special instructions and recommendations of the Croatian Institute of Public Health. More info on:

www.hzjz.hr

4. GENERAL PRINCIPLES AND RULES

To deliver a safe event during the Audi FIS Ski World Cup in Zagreb/Sljeme during the COVID-19 global pandemic, and minimise the potential risk of infection for all stakeholders: teams, media and Organiser, including all volunteers, contractors and partners, is to comply in full with national and local regulation and these Guidelines.

General principles and rules are determined by:

- current national and local COVID-19 regulations in the Republic of Croatia determined by the Croatian Institute of Public Health, the Ministry of Health, the General Directorate of Civil Protection, and the Zagreb City Civil Protection,
- these Guidelines and Test Protocol verified and approved by the Croatian Institute of Public Health and the General Directorate of Civil Protection,
- FIS COVID-19 Guidelines and Test Protocol where National Health Regulations are decisive in each Ski World Cup hosting country.

Important principles and rules:

- Individual responsibility
- Hygiene measures (frequent handwashing and disinfection)
- Maintain at least 1.5 metre of social distance wherever you go
- Wearing a mask is required at all times, in any area, both indoors and outdoors, except when: eating and drinking, staying in the hotel room, practicing sport, and for the athletes at the start and in the warming-up area
- Remain in small groups
- Avoid contact with other teams and other groups (media and Organiser's staff)
- During the leisure activities, always respect COVID-19 measures, such as: distancing, mouth-nose protection, hygiene
- Limit your leisure activities to necessary only (essential food and medicine purchase, etc.)

- Spend your free time only with members of your team/group
- Do interviews with journalists only with socially accepted distance and mouth-nose protection
- Avoid contacts with tourists/fans
- Protect the health of participating athletes and everyone involved in the event, as well as ensure that races go as planned

We ask **everyone to take full responsibility and comply with all the measures and recommendations listed above and in these Guidelines!**

There will be stewards in place to check and enforce these COVID-19 guidelines. In case of violation or non-compliance with the COVID-19 guidelines, we reserve the right to withdraw your accreditation, exclude you from the event, and take legal actions.

The Organising Committee meetings and all communication work will be held as much as possible through the usage of phone, E-mail, and video conferences.



WEARING A MASK IS REQUIRED



USE HAND SANITISER FREQUENTLY

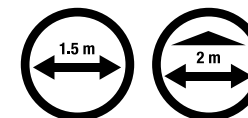

ALWAYS MAINTAIN PROPER PHYSICAL DISTANCING (2 m INDOORS, 1.5 m OUTDOORS)



DO NOT INTERACT WITH OTHER GROUPS



COMPLY WITH COVID-19 TESTING POLICY



ALERT THE MEDICAL TEAM AND THE ORGANISING COMMITTEE OF ANY SYMPTOMS AND IN CASE OF THE POSITIVE TEST RESULT, IDENTIFY ALL CLOSE CONTACTS

5. DIFFERENT SNOWFLAKES (BUBBLES) / PARTICIPATING GROUPS

The following people divided into the **following groups (Bubbles)** will be granted access to the event:

GROUP/BUBBLE	DESCRIPTION	ESTIMATED NUMBER	COVID-19 TEST CONDITIONS
<p>RED BUBBLE TEAM</p>	<ul style="list-style-type: none"> • Athletes • Coaches • Team and SRS Servicemen • Team Medical Staff • Team Support Staff • FIS Officials • Timing & Data Service • FIS sponsors handling Team 	<p>200 for women's race 200 for men's race</p>	<p>See Article 6.1.</p>
<p>YELLOW BUBBLE MEDIA</p>	<ul style="list-style-type: none"> • Host broadcaster reporters • TV broadcasters • Photographers • Journalists • TV right holder team (Infront) 	<p>10 Host broadcaster reporters (HRT) 100 TV broadcasters and journalists 30 photographers</p>	<p>See Article 6.2.</p>
<p>BLUE BUBBLE ORGANISER</p>	<p>GROUP 1 (BLUE/RED): Members of the Organising Committee in close interaction with the Teams:</p> <ul style="list-style-type: none"> • OC management • race office staff • team accreditation staff • start personnel • jury members • medical team • rescue team • timing personnel • team drivers • ski doo staff • catering in Team Hospitality • catering and front desk in Team Hotel • press conference moderator • radio centre 	<p>120</p>	<p>See Article 6.3.1.</p>

BLUE BUBBLE ORGANISER	GROUP 2 (BLUE/YELLOW): Members of the Organising Committee in close interaction with the Media: <ul style="list-style-type: none"> • press office staff • press centre staff • media accreditation staff • host broadcaster technical staff • press drivers • moderator 	100	See Article 6.3.2.
	GROUP 3: Members of the Organising Committee with no close interaction with the Teams and the Media: <ul style="list-style-type: none"> • temporary construction workers • organiser's catering staff • transport organisation staff • organiser's accreditations • fire workers • event suppliers' staff • security • race course workers • race course crew • slippers • judges • ski lift personnel • marketing team • other hotel staff • others 	300	See Article 6.3.3.

Spectators and guests:

- races will be held without spectators and guests

6. COVID-19 TEST PROTOCOL

Requirements for the accreditation:

6.1. RED BUBBLE – TEAM TESTING PROTOCOL

- Negative Covid-19 PCR test (saliva or swab test) result not older than 72 hours at the time of the accreditation pick-up (counting from the collection of the sample)

or

- positive Covid-19 PCR test between 90 days and 14 days prior to the time of the accreditation pick-up.
- Individuals with a positive PCR test within 14 days prior to the accreditation pick-up cannot participate in the event.
- Presentation of a positive COVID-19 antibody test is not recognised.

Test taken outside of Croatia:

- The PCR test presented needs to be recognised by the health authority of the respective country.

Test costs:

- All costs for testing shall be paid by the team/individual person.

6.2. YELLOW BUBBLE – MEDIA TESTING PROTOCOL

- Negative Covid-19 PCR test (saliva or swab test) result not older than 72 hours at the time of the accreditation pick-up (counting from the collection of the sample)

or

- positive Covid-19 PCR test between 90 days and 14 days prior to the time of the accreditation pick-up.
- Individuals with a positive PCR test within 14 days prior to the accreditation pick-up cannot participate in the event.
- Presentation of a positive COVID-19 antibody test is not recognised.

Test taken outside of Croatia:

- The PCR test presented needs to be recognised by the health authority of the respective country.

Test costs:

- All costs for testing shall be paid by the media/individual person.

6.3.1. BLUE BUBBLE – ORGANISER TESTING PROTOCOL - GROUP 1 (BLUE/RED)

- Negative Covid-19 PCR test (saliva or swab test) or Antigen test result not older than 72 hours at the time of the accreditation pick-up (counting from the collection of the sample)

or

- positive Covid-19 PCR test between 90 days and 14 days prior to the time of the accreditation pick-up.
- Individuals with a positive PCR test within 14 days prior to the accreditation pick-up cannot participate in the event.
- Presentation of a positive COVID-19 antibody test is not recognised.

Test taken outside of Croatia:

- The PCR test presented needs to be recognised by the health authority of the respective country.

Test costs:

- All costs for testing shall be paid by the Organising Committee.

Other conditions:

- Filled out Pre-Event Health Questionnaire without answer YES to any question – Appendix 1.

6.3.2. BLUE BUBBLE – ORGANISER TESTING PROTOCOL - GROUP 2 (BLUE/YELLOW)

- Negative Covid-19 PCR test (saliva or swab test) or Antigen test result not older than 72 hours at the time of the accreditation pick-up (counting from the collection of the sample)

or

- positive Covid-19 PCR test between 90 days and 14 days prior to the time of the accreditation pick-up.
- Individuals with a positive PCR test within 14 days prior to the accreditation pick-up cannot participate in the event.
- Presentation of a positive COVID-19 antibody test is not recognised.

Test taken outside of Croatia:

- The PCR test presented needs to be recognised by the health authority of the respective country.

Test costs:

- All costs for testing shall be paid by the Organising Committee.

Other conditions:

- Filled out Pre-Event Health Questionnaire without the answer YES to any question – Appendix 1.

6.3.3. BLUE BUBBLE – ORGANISER TESTING PROTOCOL - GROUP 3

Other conditions:

- Filled out Pre-Event Health Questionnaire without the answer YES to any question – Appendix 1.

If you have any specific questions related to test protocols and testing itself, please contact the Organising Committee COVID-19 Coordinator.

7. FIS COVID-19 PASSPORT

The International Ski Federation-FIS introduced the FIS COVID-19 Passport for the season 2020/2021 for all Team (Red Bubble) and Media (Yellow Bubble) representatives.

Main four functions of the FIS Passport are the following:

1. **Upload of the test result**
2. **“Whereabouts” for the last 14 days**
3. **Health Pre-Event Questionnaire**
4. **Daily Health Questionnaire**

Conditions to get accreditation for each person from “Red” (Team) and “Yellow” (Media) Bubble:

- The following **must be filled out in the FIS Passport by 10 a.m. on the day when accreditations are to be collected:**
 - uploaded negative Covid-19 PCR Test (saliva or swab test) result not older than 72 hours at the time of the accreditation pick-up (counting from the collection of the sample) or positive Covid-19 PCR test between 90 days and 14 days prior to the time of the accreditation pick-up;
 - filled out “Whereabouts” for the last 14 days;
 - filled out “Health Pre-Event Questionnaire”;
- Filled out Daily Health Questionnaire, which will be sent to E-mails/ WhatsApp of all accredited persons in the mornings of the training and competition days. It must be filled out prior to entering the race venue (Gondola).

The Covid-19 LOC Coordinator checks each registration and authorises issuing of an accreditation. Should there be any problem or in case of any doubts, the Team Captain will be immediately contacted by the Covid-19 LOC Coordinator and informed about what actions to be taken.

8. HEALTH AND SAFETY PROTOCOL BY ZONES

Each section includes specific measures, rules and suggestions given the exceptional circumstances. Information in this document is being updated regularly as the epidemic situation in Croatia and surrounding countries change.

8.1. ARRIVAL TO ZAGREB

- Do not travel to Zagreb if showing COVID-19 symptoms.
- On travel to Zagreb, avoid stopovers (make only necessary stopovers).
- On travel to Zagreb, avoid contact with other people, especially outside your team.

8.2. AIRPORT ARRIVAL

- All persons arriving to Zagreb by an airplane should wear a mask at all times during their flight, at the airport, and during transportation to their hotel
- Use hand sanitisers available at the airport
- LOC drivers will wear masks at all times and will have Covid-19 negative test results

8.3. AIRPORT DEPARTURE

- **IMPORTANT FOR ALL CHARTER FLIGHT PASSENGERS TO BERN (SUI) ON JANUARY 7, 2021:**
- **All charter flight passengers must be tested and then upload the negative Covid-19 PCR Test (saliva or swab test) result not older than 72 hours** at the time of the flight departure (counting from the collection of the sample) **or the positive Covid-19 PCR Test between 90 days and 14 days** prior to the time of the flight departure **in the FIS Passport by January 7, 2021, until 9 a.m.!**

- All persons traveling to the airport should wear a mask at all times during the transportation, at the airport, and during their flight, except when eating or drinking.
- LOC drivers will wear masks at all times and will have Covid-19 negative test results.
- Use hand sanitisers available at the airport.

8.4. ACCREDITATION

TEAM (RED BUBBLE) ACCREDITATION

- Requirements to obtaining accreditations are described in the **Points 6.1** and **7** of these Guidelines
- Pick-up of accreditations, parking permits and course access **at the Team Accreditation office in the "Maksimir" Hall in The Westin Zagreb Hotel NEW! (entrance from the outside -west side, next to the entrance to the "World Class" gym)**
- Access is allowed only to **one representative per nation** (usually Team Captain)
- **Pick up accreditation prior to entering the hotel and before checking in**
- **Entering the hotel without accreditation is not allowed**
- All documents for each nation will be prepared in advance
- Masks are mandatory
- Hand sanitisers are available

As the Organiser of the event, we are required to limit the number of accredited people due to the COVID-19 situation. Therefore, only the team officials are granted access to team and sports relevant areas, in line with the respective FIS quotas. People outside the applicable FIS quota are not allowed to enter the above-mentioned areas, and do not have the possibility to stay at Teams' accommodation!

MEDIA (YELLOW BUBBLE) ACCREDITATION

- Requirements to obtaining accreditations are described in the **Points 6.2** and **7** of these Guidelines
- Pick-up of accreditations and parking permits (on request) in person **at the Press Accreditation Office at the Café Imperial (entrance through the hotel lobby) in Sheraton Zagreb Hotel, Ulica kneza Borne 2, Zagreb**
- Masks are mandatory
- Hand sanitisers are available

ORGANISER (BLUE BUBBLE) ACCREDITATION

- Requirements to obtaining accreditations are described in the **Points 6.3** and **7** of these Guidelines
- Pick-up of accreditations and parking permits (on request) in person **at the Organising Committee Accreditation office at the Café Imperial (entrance from Draškovićeve street) in Sheraton Zagreb Hotel, Ulica kneza Borne 2, Zagreb**
- Masks are mandatory
- Hand sanitisers are available

8.5. TRANSPORTATION

TEAM (RED BUBBLE) TRANSPORTATION

- **Use own team vehicle for transport if possible**
- Parking permits for respective parking area are necessary
- Avoid stops on the way from the hotel to the venue
- For those Teams and FIS officials requiring transportation, the same will be organised by LOC shuttle transportation from The Westin Zagreb Hotel to the new gondola and back, in separate cars and/or mini buses without any interaction with other bubbles and with dedicated Red Bubble drivers

- LOC drivers will wear masks at all times and will have Covid-19 negative test results
- Maximum number allowed is 3 persons per car and 5 persons per minivan
- Regular cleaning of all vehicles
- Masks are mandatory for all passengers
- Hand sanitisers available in all vehicles

MEDIA (YELLOW BUBBLE) TRANSPORTATION

- **Use own press vehicle for transport, if possible**
- Parking permits for respective parking area are necessary
- Avoid stops on the way from the hotel to the venue
- For those Media representatives requiring transportation, the same will be organised by LOC shuttle transportation from Sheraton Zagreb Hotel to the finish area and back, in separate cars and/or mini buses without any interaction with other bubbles and with dedicated Yellow Bubble drivers
- LOC drivers will wear masks at all times and will have Covid-19 negative test results
- Maximum number allowed is 3 persons per car and 5 persons per minivan
- Regular cleaning of all vehicles
- Masks are mandatory for all passengers
- Hand sanitisers available in all vehicles

ORGANISER (BLUE BUBBLE) TRANSPORTATION

- **Transport with own/group vehicles only**
- Parking permits for respective parking area are necessary
- Avoid stops on the way from the hotel to the venue

8.6. ACCOMMODATION

8.6.1. TEAM HOTEL – THE WESTIN ZAGREB HOTEL

All teams and FIS officials (Red Bubble) will be accommodated in the The Westin Zagreb Hotel, which will be closed for the outside guests and will be access-only for the Red Bubble accredited group!

- Entry to the hotel without accreditation is not allowed (security check at the entrance)
- Temperature check at the entrance
- Check in/check out: one team person (usually a Team Captain) to handle all hotel matters
- Lobby seating area will be rearranged to facilitate physical distancing
- Access to the hotel rooms and garage by using the 4 elevators dedicated to the Red Bubble
- Wearing a mask is mandatory at all times, except when in the rooms, and when eating and drinking
- The hotel personnel on site will be wearing facial masks and gloves
- Hand sanitisers available in key areas throughout the hotel
- Front desk plexi-glass separation
- All hotel personnel in contact with the teams will have negative PCR test results

Accommodation calculation:

- Will be sent out to the Teams by E-mail
- In case of any doubts that cannot be solved by E-mail or by phone, a Team Captain will schedule a meeting with the Race Office
- Race Office will notify the front desk of the hotel about the accommodation calculation for each team by E-mail

Rooms:

- Teams will be assigned their dedicated floors
- Single rooms will be distributed as much as possible
- Maintain appropriate distancing between twin beds
- Housekeeping service will be provided only on request and without guests in their rooms

Meals:

- **there will be two large dining rooms:**
 - **Restoran Kaptol**
 - **2/3 of Crystal Hall (ex-Team Captain's Meeting room)**
- **dedicated tables per teams (nations' assignments will be posted at the entrance to each dining room)**
- distance between tables will be 2 meters
- maximum occupancy per round table for ten will be six persons
- bottled water/beverages will be distributed in advance at each table
- buffet-style meals, but with no self-service system - cooks with masks and gloves will serve a requested dish on a plate
- masks are mandatory except when eating and drinking

Ski waxing rooms:

- Located in the garage of The Westin Zagreb Hotel
- Dedicated box for each team (or maximum two teams in one box)
- Mask are mandatory
- Hand sanitisers available

8.6.2. MEDIA HOTEL – SHERATON ZAGREB HOTEL

All Media (Yellow Bubble) will be accommodated in Sheraton Zagreb Hotel.

- Temperature check on entrance
- Lobby seating area rearranged to facilitate physical distancing
- Access to the hotel rooms and garage using dedicated elevators
- Wearing a mask is mandatory at all times, except when in the rooms, and when eating and drinking
- The hotel personnel on site will be wearing facial masks and gloves
- Hand sanitisers available in key areas throughout the hotel
- Front desk plexi-glass separation

Rooms:

- Media will be assigned their dedicated floors
- Single rooms will be distributed as much as possible
- Maintain appropriate distancing between twin beds
- Housekeeping service will be provided only on request and without guests in their rooms

Meals:

- dining in the Opereta Hall exclusively for Media representatives
- distance between tables 2 meters
- maximum allowed occupancy per table will be respected
- dining à la carte with a possibility to choose from two different menus
- masks are mandatory, except when eating and drinking

8.6.3. ORGANISING COMMITTEE HOTEL – HOTEL TOMISLAVOV DOM

- The right wing will be dedicated for the Organising Committee workers
- Side entrance will be dedicated for the Organising Committee workers
- The right-side elevators will be dedicated for the Organising Committee workers
- Wearing a mask is mandatory at all times, except when in the rooms, and when eating and drinking
- The hotel personnel on site will be wearing facial masks and gloves
- Hand sanitisers available in key areas throughout the hotel
- Front desk plexi-glass separation

Rooms:

- Rooms in the right wing dedicated for the Organising Committee workers
- Single rooms will be distributed as much as possible
- Maintain appropriate distancing between twin beds
- Housekeeping service will be provided only on request and without guests in their rooms

Meals:

- meals for the Organising Committee workers will be served in the hotel's main restaurant
- distance between tables will be 2 meters
- maximum allowed occupancy per table will be respected
- bottled water/beverages will be distributed in advance at each table
- buffet-style meals, but with no self-service system - cooks with masks and gloves will serve a requested dish on a plate
- masks are mandatory, except when eating and drinking

8.6.4. ORGANISING COMMITTEE HOTEL – APT. SNJEŽNA KRALJICA:

- The entire hotel will be dedicated for the Organising Committee workers
- Wearing a mask is mandatory at all times, except when in the rooms, and when eating and drinking
- Hotel personnel on site will be wearing facial masks and gloves
- Hand sanitisers available in key areas throughout the hotel
- Front desk plexi-glass separation

Rooms:

- Maintain appropriate distancing between twin beds
- Housekeeping service will be provided only on request and without guests in their rooms

Meals:

- meals for the Organising Committee workers will be served in the hotel's main restaurant
- distance between tables will be 2 meters
- maximum allowed occupancy per table will be respected
- bottled water/beverages will be distributed in advance at each table
- buffet-style meals, but with no self-service system - cooks with masks and gloves will serve a requested dish on a plate
- masks are mandatory, except when eating and drinking

8.7. TEAM CAPTAINS' MEETING

- Team Captain's Meeting will be held in the 1/3 Crystal Hall of The Westin Zagreb Hotel
- Only one representative per nation is allowed, plus those strictly necessary to attend from FIS officials, Timing and LOC representatives
- Distance of 2 meters between the tables
- Masks are mandatory
- Hand sanitisers available

8.8. MAIN RACE OFFICE – THE WESTIN ZAGREB HOTEL

- Race office in The Westin Zagreb Hotel will be handled primarily online (phone, E-mail, video conference)
- In case a meeting is necessary, it will be only a short meeting with just one person from the team, and by appointment only
- All Team information will be sent by E-mail to the Teams
- The accommodation calculation will be sent by E-mail
- Masks are mandatory
- Hand sanitisers available

8.9. PARKING

- Parking in front of The Westin Zagreb Hotel and in The Westin Zagreb Hotel garage for Teams (Red Bubble) only
- Media parking in the Sheraton Zagreb Hotel garage
- Parking in the new gondola garage for Teams (Red Bubble) only
- Parking on the top of Sljeme for the Organising Committee workers (Blue Bubble) only
- Parking on “Krumpirište” for the Organising Committee workers (Blue Bubble) and media (Yellow Bubble) separately
- Parking in the finish area for TV trucks (Yellow Bubble) only
- Parking in “Kamenolom” in Gornja Bistra for the Organising Committee workers (Blue Bubble) only
- Use only allocated and marked parking

8.10. GYM

- Gym in The Westin Zagreb Hotel will be closed
- Physical training for the Teams will be possible outdoors only, on the playground across the street from The Westin Zagreb Hotel (“Srednjoškolsko igralište”)

8.11. PUBLIC DRAW & SIDE EVENTS

- No public draw and no side events will be held

8.12. NEW GONDOLA (CABLE CAR)

- **NEW GONDOLA: from Zagreb (Gračani) to the top of Sljeme – direct exit to the Team Hospitality**
- parking in the gondola garage on floors -1 and -2, exclusively reserved for Teams (Red Bubble)
- parking tickets and parking permits will be distributed at the time of accreditation
- **gondola will be used for Teams (Red Bubble) only!**
- maximum loading capacity: 4 persons in cabins for 10 persons
- preferable loading of members of the same team in one cabin
- masks are mandatory
- hand sanitisers available

8.13. THE RACE VENUE

- **The Race Venue (Ski resort Sljeme) will be closed for public in the period from January 2 to January 6, and access will be allowed to accredited persons only**
- Keep minimum social distance (1.5 m outdoors, 2 m indoors)
- Wearing a mask is mandatory at all times and in every area, both indoors and outdoors, except when: eating and drinking, athletes skiing, and athletes at the start and in the warming-up area
- Stay only within the allocated and marked zones for each Bubble
- Avoid direct contact with other Bubbles
- For Teams:
 - Avoid direct contact with other teams
 - Avoid direct contact with staff/press

8.13.1. TOP OF SLJEME

- In the period from January 2 to January 6, the entire top area, including parking from the main street entrance, Restaurant Medveščak Kućica, Restaurant Zlatni Medvjed, Restaurant Vidikovac and Top station of New Gondola, will be for accredited persons only

8.13.2. TEAM HOSPITALITY

- located in the Restaurant Vidikovac and in two tents (150 m2 and 75 m2) next to it, at the top of Sljeme Ski Resort, just below the TV tower (3 separate areas in Vidikovac Restaurant + two tents in addition – in total five separate areas)
- connected with the Red Bubble corridor from top of gondola and top of chairlift
- strict access control at the entrance
- disinfecting the night before the Teams enter
- increased frequency of cleaning
- **Teams will be assigned dedicated zones and tables (nations' table assignments will be posted at the entrance to each zone)**
- distance between tables will be 2 meters
- maximum allowed occupancy per table will be respected
- bottled water/beverages will be distributed in advance at each table
- buffet-style meals, but with no self-service system - cooks with masks and gloves will serve a requested dish on a plate
- masks are mandatory, except when eating and drinking
- hand sanitisers available

8.13.3. SKI CHAIRLIFT

- Two separate entrance to access the ski chairlift:
 - for Teams (Red Bubble)
 - for Organiser (Blue Bubble)
- Middle seat on triple-chair lift will be kept free (maximum 2 persons loading)
- Only the same Bubble (Red or Blue) members should share the same chair
- Preferable loading of the members of the same team in one chair
- Masks are mandatory
- Physical distancing when waiting for the chairlift

8.13.4. START AREA

- Entrance allowed to: Teams, start referee, starter order staff, bib crew, Host broadcaster and Timing
- Accreditation check at the entrance
- Masks are mandatory, except for the athletes at the start and during the warm-up

8.13.5. START BIB'S DISTRIBUTION

- For TV Bib Presentation (1-10) in the finish area by one LOC representative wearing a mask, after presentation collecting the bibs again
- Distribution of bibs at the start
- One representative from LOC wearing the mask

8.13.6. RACE COURSE

- Masks are mandatory, except for the workers when working (shovelling snow)
- Physical distance to be respected

8.13.7. TIMING ROOM

- Masks are mandatory
- Hand sanitisers available

8.13.8. FINISH AREA CORRIDORS:**8.13.8.1. TEAM 1 AND 2 FINISH ZONES**

- Very strict limited number of people, one or maximum two persons per nation + SRS representatives
- Masks are mandatory
- Hand sanitisers available
- Athletes can change in the designated tent
- Divided by 1.5 m separation from the Press zone

8.13.8.2. PRESS AND RADIO ZONE

- Very strict limited number of accredited people
- Divided by 1.5 m separation from the Team area
- No cell/smart/mobile phones or similar devices, only proper microphones. Microphones should be wiped with approved disinfectant wipes before and after the use.
- Masks are mandatory
- Hand sanitisers available

8.13.8.3. LIVE TV BOX

- Divided by 1.5 m separation between the presenter and athletes
- Interviews only from a distance with a long mic stand, mic cover

must be changed between each interview, only the presenter and cameraman are allowed to be present.

- Masks are mandatory.

8.13.8.4. TV ENG AREA

- 1.5 m separation between a journalist and athletes
- Very strict limited number of accredited people
- Interviews only from a distance with a long mic stand, mic cover must be
- changed between each interview, only the presenter and cameraman are allowed to be present
- Masks are mandatory.

8.13.8.5. FIS MATERIAL CONTROL TENT

- Masks are mandatory
- Hand sanitisers available

8.13.8.6. MEDICAL TEAM AREA

- Masks are mandatory
- Hand sanitisers available

8.13.8.7. AWARD CEREMONY

- At the end of the races in the finish area
- Without presenters
- Trophy and prizes will be placed on the podium
- No handshakes when handing out trophies
- Social distancing between the athletes on the podium
- Masks are mandatory

8.13.9. RACE OFFICE

- Race office on the race days in the Restaurant Jezero – separate entrance
- No team members allowed to enter, communication only by E-mail, video conference or phone call
- Masks are mandatory
- Hand sanitisers available

8.13.10. SKI PREPARATION AREA

- On the race days, the ski waxing area with tables, lights, and heating for the preparation of skis between the two runs will be located in the garage of top station of the chairlift
- Garage door will be open for better ventilation
- Masks are mandatory
- Hand sanitisers available

8.13.11. ANTI-DOPING CONTROL

- If required, it will be held in the Team Hospitality at the end of the race, after the press conference
- Masks are mandatory at all times
- Social distance of at least 2 meters to be respected

8.13.12. MEDICAL FACILITIES

- Masks are mandatory
- Hand sanitisers available

8.14. MEDIA & BROADCASTERS FACILITIES

8.14.1. PRESS OFFICE

- The Press office will be open for all necessary information to the Press at Sheraton Zagreb Hotel

- It will be handled primarily online (phone, E-mail, video conference)
- In case of a necessary meeting, it will be only a short meeting with just one person from the press, and by appointment only
- All Press information will be sent by E-mail to the Press
- Masks are mandatory
- Hand sanitisers available

8.14.2. PRESS CONFERENCE

- Press conference for the top three racers of each race will be held via video link from the Team Hospitality
- Presenter will have PCR negative test results
- Masks are mandatory
- Hand sanitisers available

8.14.3. PRESS CENTRE AND PHOTO CORNER

- There will be no Main Press centre in The Westin Zagreb Hotel
- Press centre and Photo corner on the race days will be located in the finish area in the Restaurant "Jezero"
- Very limited number of press representatives with allowed entrance
- Divided in two groups (press and photo) and two areas per each group, determined according to required square meter area per person:

photo 1:	7 working places
photo 2:	10 working places
press 1:	10 working places
press 2:	11 working places

- Mask are mandatory
- Hand sanitisers available

8.14.4. HOST BROADCASTER TV TRUCK

- Very limited number of persons will be allowed entrance - exclusively persons from the TV production
- All persons must have PCR negative test results
- Mask are mandatory
- Hand sanitisers available

8.14.5. MEDIA HOSPITALITY

- Located in the finish area, behind the grandstand
- Three small huts for the food preparation
- Distribution of the food through the windows
- Food prepared for take-away
- High tables for the outdoor sitting
- Distance between the tables will be 2 meters
- Maximum occupancy per table will be respected
- Masks are mandatory, except when eating and drinking
- Hand sanitisers available

8.15. ORGANISER HOSPITALITY

Before and between the race days:

- will be served in the Restaurant Vidikovac
- served in smaller groups of 10-15 persons
- distance between the tables will be 2 meters
- maximum allowed occupancy per table will be respected
- bottled water/beverages distributed in advance at each table
- table serving with a possibility to choose from two different menus
- masks are mandatory, except when eating and drinking

On the race days (before and after the race):

- will be served in the Restaurant Zlatni Medvjed and Medveščak "Kućica"
- served in smaller groups of 10-15 persons
- distance between the tables will be 2 meters
- maximum allowed occupancy per table will be respected
- bottled water/beverages distributed in advance at each table
- table serving with a possibility to choose from two different menus
- masks are mandatory, except when eating and drinking

On the race days (between the two runs):

- Located in the finish area, at the bottom station of the chairlift
- One tent for the food preparation
- Distribution of the food through the tent window
- Food prepared for take-away
- Masks are mandatory, except when eating and drinking
- Hand sanitisers available

9. ONSITE COVID-19 TESTING FACILITIES INCLUDING MAPS

Testing facilities are located at following addresses and with the following opening hours:

9.1. THE WESTIN ZAGREB HOTEL

For Teams requiring PCR Test to travel from Croatia to other countries and other ski races:

The Westin Zagreb Hotel
 Zrinjevac/Tuškanac Hall (next to the front desk)
 Kršnjavoga 1
 HR-10000 Zagreb

Samples collecting times:

Saturday, January 2 , 2021	17:30 – 20:00 PCR Covid-19 testing for women's teams
Sunday, January 3 , 2021	18:30 – 19:30 PCR Covid-19 testing for women's teams (valid for World Cup races in St. Anton)
Tuesday, January 5 , 2021	17:30 – 20:00 PCR Covid-19 testing for men's teams (valid for the charter flight to Bern and World Cup races in Adelboden)

Price per PCR test: 698.21 HRK (approximately 93.00 EUR)

Payment: Credit card

Test result: By E-mail within 24 hours

Note: Bring your ID / Passport

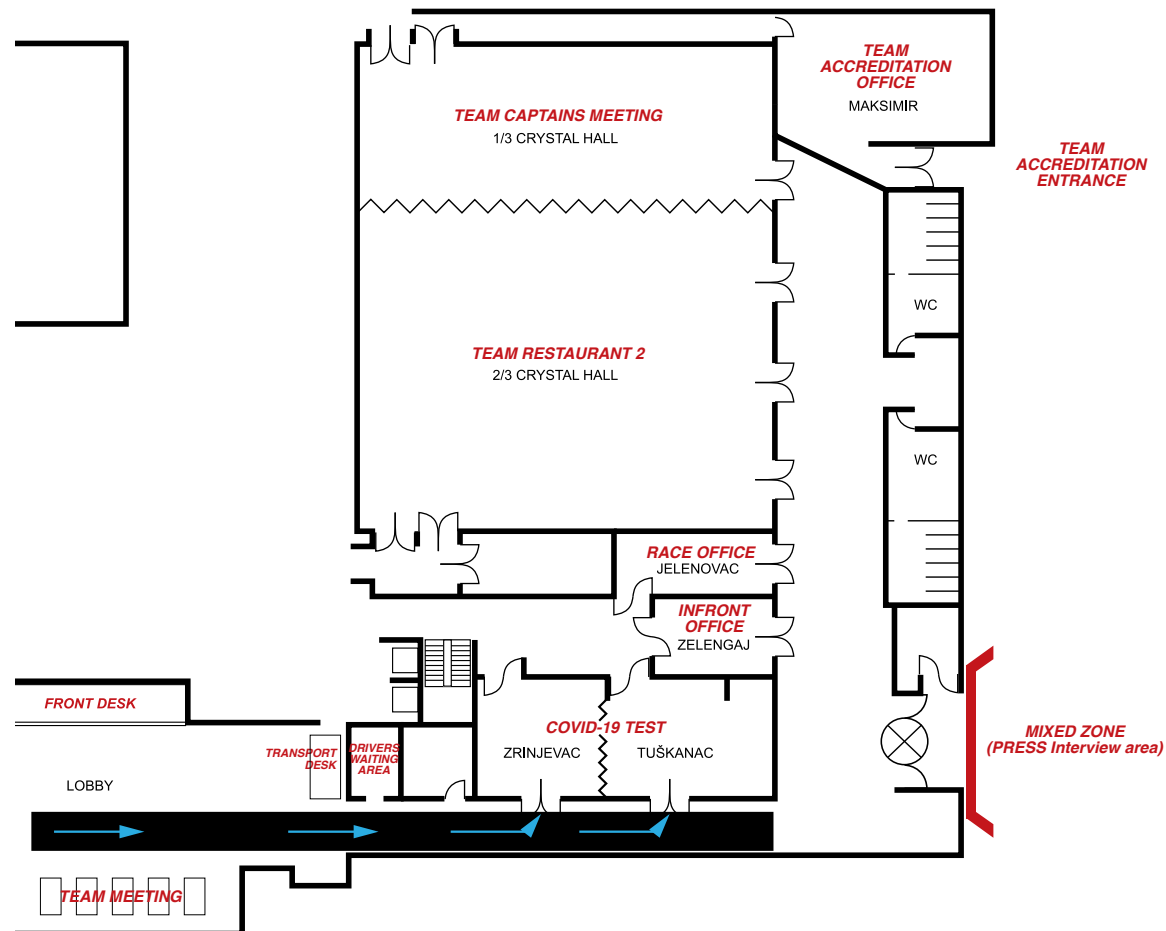

9.2. CROATIAN INSTITUTE OF PUBLIC HEALTH

Rockefeller str. 7
 HR - 10000 Zagreb
 Phone: +385-1-4863 366
 E-mail: covid@hzjz.hr

Test type: PCR
Price per PCR test: 698.21 HRK (approximately 93.00 EUR)
Payment: Credit card
Test result: By E-mail within 24 hours
Note: Bring your ID / Passport
 Drive-through testing

Working hours:

Friday, January 1 , 2021	closed
Saturday, January 2 , 2021	08:00– 10:00
Sunday, January 3 , 2021	closed
Monday, January 4 , 2021	07:30 – 09:30
Tuesday, January 5 , 2021	07:30 – 09:30
Wednesday, January 6 , 2021	TBA
Thursday, January 7 , 2021	07:30 – 09:30

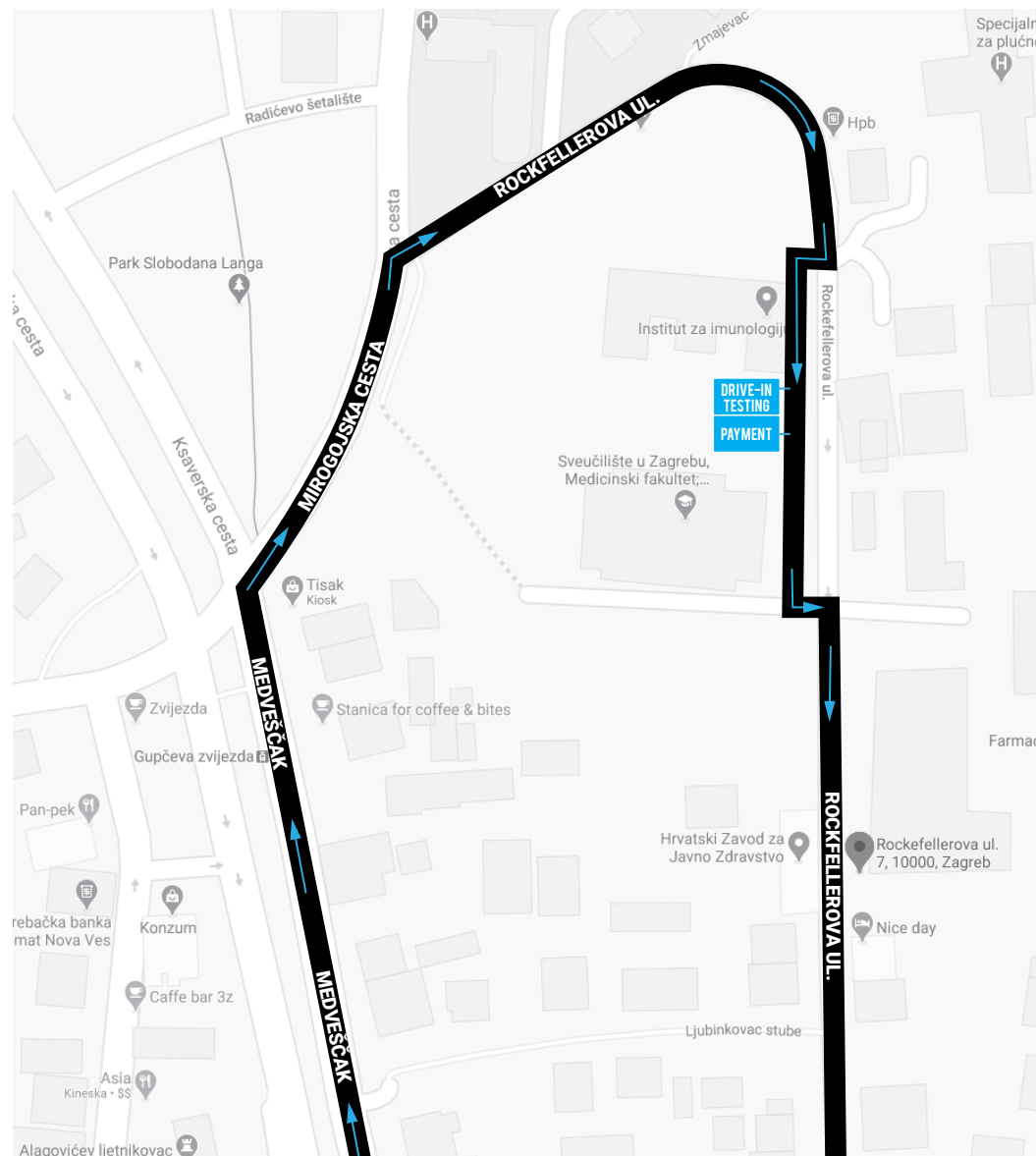

9.3. "DR. ANDRIJA ŠTAMPAR" TEACHING INSTITUTE OF PUBLIC HEALTH

Mirogojska 16
 HR - 10000 Zagreb
 Phone:
 E-mail:

+385-1-4696 308; +385-1-4696 315
 covidinfo@stampar.hr

Test type: PCR
Price per PCR test: 698.21 HRK (approximately 93.00 EUR)
Payment: Credit card
Test result: By E-mail within 24 hours
Note: Bring your ID / Passport
 Drive-through testing

Working hours:

Friday, January 1 , 2021	closed
Saturday, January 2 , 2021	10:00 – 14:00
Sunday, January 3 , 2021	08:00 – 12:00
Monday, January 4 , 2021	10:00 – 16:00
Tuesday, January 5 , 2021	10:00 – 16:00
Wednesday, January 6 , 2021	10:00 – 12:00
Thursday, January 7 , 2021	10:00 – 16:00

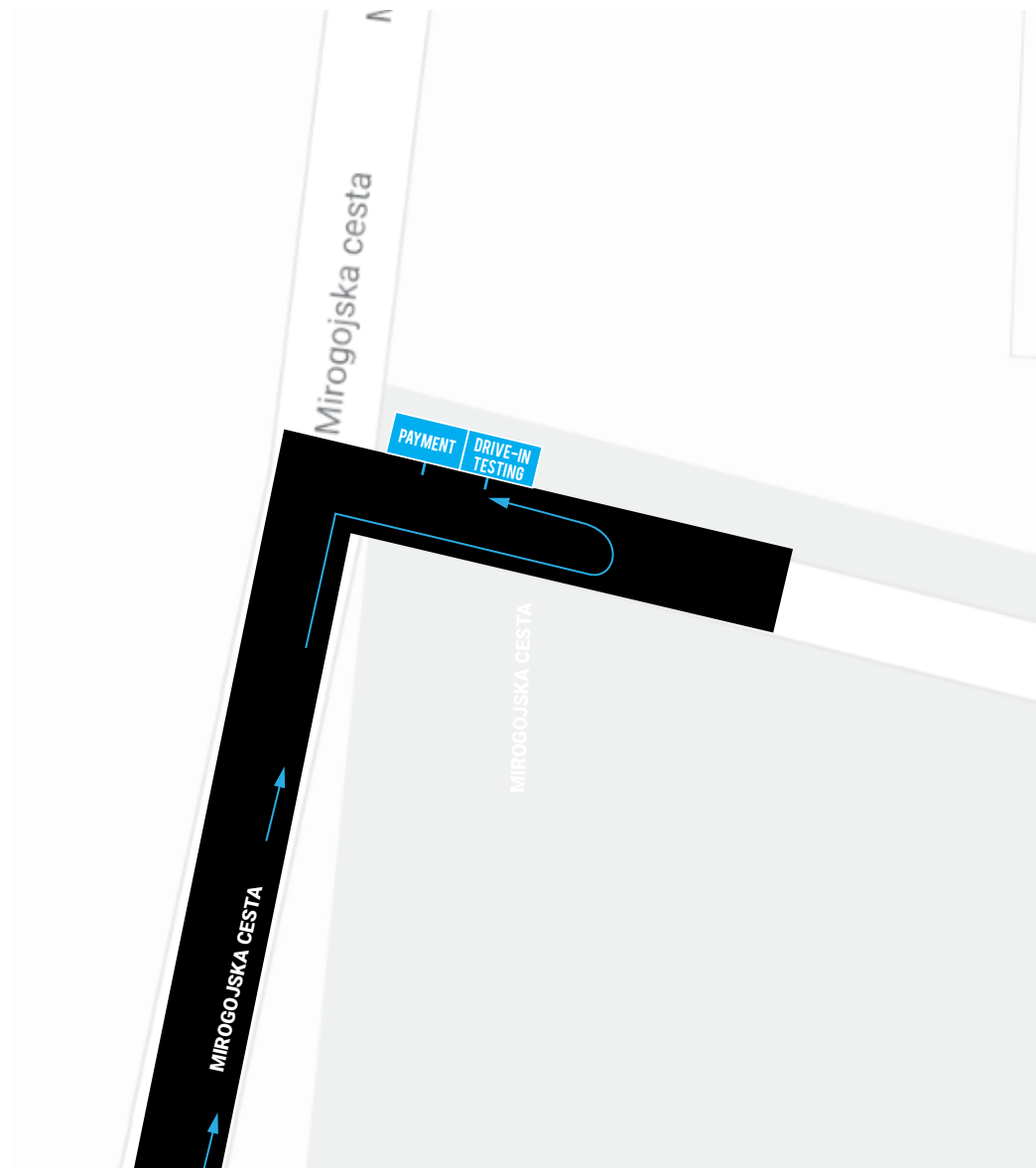

9.4. ANTIGEN RAPID TESTS

9.4.1. POLYCLINIC LABPLUS ZAGREB

Maksimirska cesta 282

HR - 10000 Zagreb

Phone: +385-1-7987-470

E-mail: info-zg@poliklinika-labplus.hr

Test type:	Antigen SARS-CoV-2
Price per Antigen test:	250.00 HRK (approximately 33.00 EUR)
Payment:	Credit card
Test result:	By E-mail within 1 hour
Note:	Bring your ID / Passport Drive-through testing Mandatory phone/E-mail appointment

Working hours:

Friday, January 1, 2021	closed
Saturday, January 2, 2021	TBA
Sunday, January 3, 2021	TBA
Monday, January 4, 2021	07:30 – 16:00
Tuesday, January 5, 2021	07:30 – 16:00
Wednesday, January 6, 2021	closed
Thursday, January 7, 2021	07:30 – 16:00

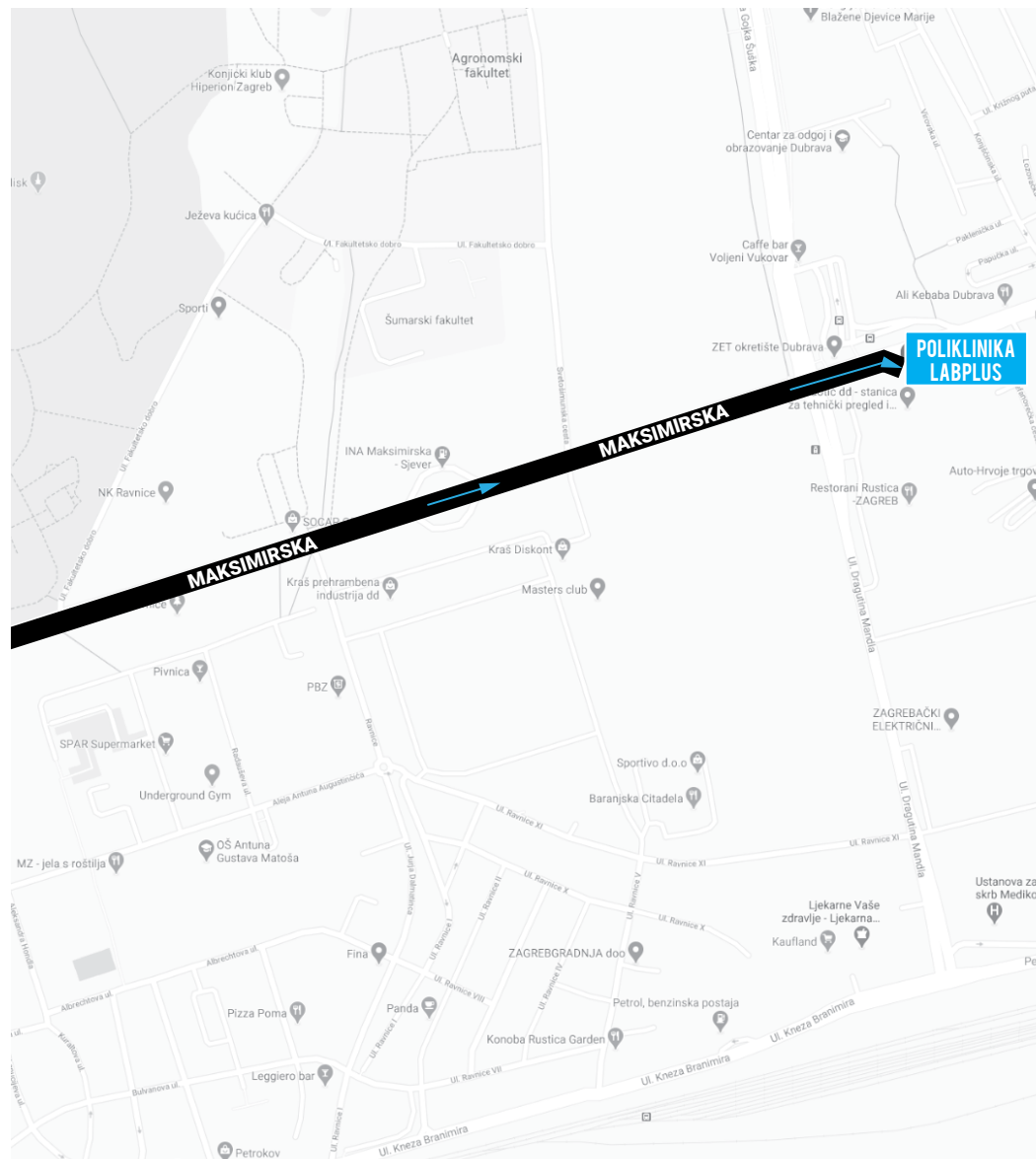

9.4.2. SPECIALTY HOSPITAL “SV. KATARINA” ZAGREB

Trpinjska ulica 7
 HR-10000 Zagreb
 Phone: +385-1-2867 400
 E-mail: info@svkatarina.hr

Test type: Antigen SARS-CoV-2
Price per Antigen test: 350.00 HRK (approximately 46.00 EUR)
Payment: Credit card
Test result: By E-mail within 1 hour
Note: Bring your ID / Passport
 Drive-through testing
 Mandatory phone/E-mail appointment

Working hours:

Friday, January 1 , 2021	closed
Saturday, January 2 , 2021	07:30 – 15:00
Sunday, January 3 , 2021	closed
Monday, January 4 , 2021	07:30 – 19:00
Tuesday, January 5 , 2021	07:30 – 19:00
Wednesday, January 6 , 2021	closed
Thursday, January 7 , 2021	07:30 – 19:00



10. COVID-19 PROTOCOL IN CASE OF SYMPTOMS

- Determined by the current national regulation of the Republic of Croatia
- Protocol developed with and verified by the Croatian Institute of Public Health
- **In case of COVID-19 symptoms, inform immediately the Organising Committee COVID-19 Coordinator:
Dr. Nataša Desnica, Mobile: +385-91-3093 028**
- Symptoms of the Corona disease and infection are: fever, cough, shortness of breath, breathing difficulties, loss of smell and taste
- The Organising Committee will activate Covid-19 measures in accordance with national regulation for Covid-19 suspect case management
- In case you show symptoms and if isolation will be necessary until COVID-19 test result arrive, there will be an isolation room provided
- In case of positive test results, a 10-day quarantine from the day of first symptoms will be required in the hotels or at the locations determined by the Zagreb City Civil Protection
- In case of a positive test result, the national and local authorities will decide on a possible quarantine of other people with whom close contact might have occurred (e.g. team members).
- A dedicated Covid-19 ambulance can be immediately activated if needed
- Please note that since the costs of hospitalisation, quarantine/isolation, testing, etc. should be carried by the infected person, we suggest that you check that they are covered by your health insurance.

LOC COVID-19 Coordinator contact:

Dr. Nataša Desnica

E-mail: natasa.desnica@gmail.com

Mobile: +385-91-3093 028

11. FIS COVID-19 COMMUNICATION POLICY

FIS World Cup Communications flow for a Covid-19 positive test

Should an individual directly involved with any FIS World Cup competition tests positive for Covid-19, the following procedures will be implemented to assure the communication flow.

This applies to all stakeholders: team support personnel, equipment technicians, broadcasters and rights holders, event service support, etc.

Upon receipt of a positive test, the team/individual shall immediately inform the FIS contact person on site (Race/Contest Director). The Race Director will inform the FIS Event Task Force (one representative: FIS, LOC, NSA and the LOC Health Coordinator, FIS C-19 Expert) of the situation, who will assess the necessary next steps.

No external communication may be made by the team/individual until the FIS Event Task Force has assessed the circumstances.

Once the assessment is made, official information firstly to the designated contact for the positive case to inform about the communication flow. The first external information will be made through the FIS Official Communication system. It will not contain names of individuals involved, or details. It is meant strictly to inform that a person has tested positive and about any necessary next steps involved.

Should timing be appropriate and all parties agree, the information can also be communicated by the FIS Race Director at the Team Captains Meeting to facilitate additional communication to the key stakeholder group, namely the athletes. Following any announcement at a TCM, the FIS Official Communication will still be sent and if cleared information about the person involved if this is cleared.

At this time, the teams/individuals may also put out information to the media with more details about the positive case, if desired.

Following the Official Communication, FIS will only answer media inquiries that pertain directly the competition and any impact on the calendar. All health and team-related questions will be referred to the team/individual/group involved.

12. MAPS

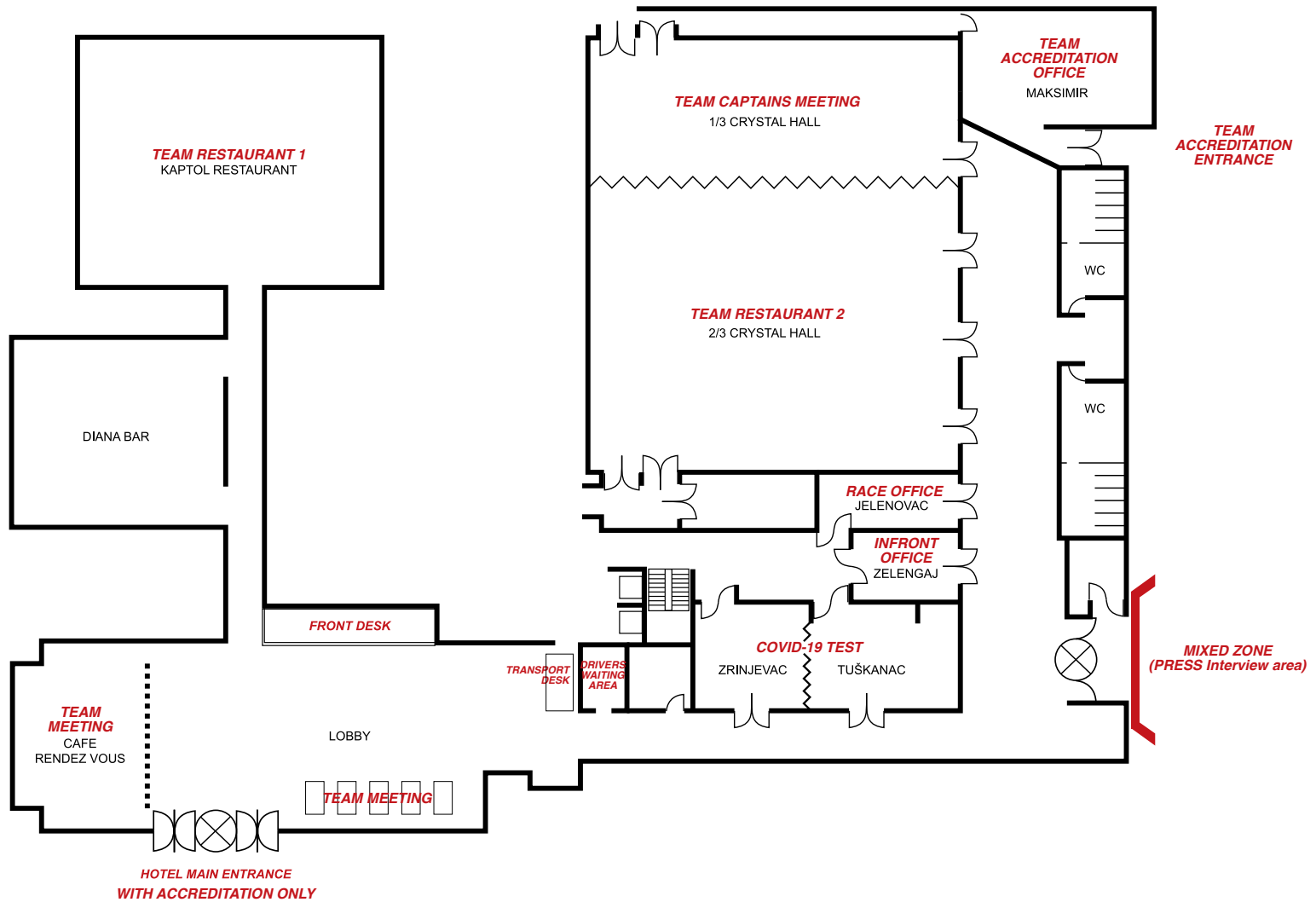

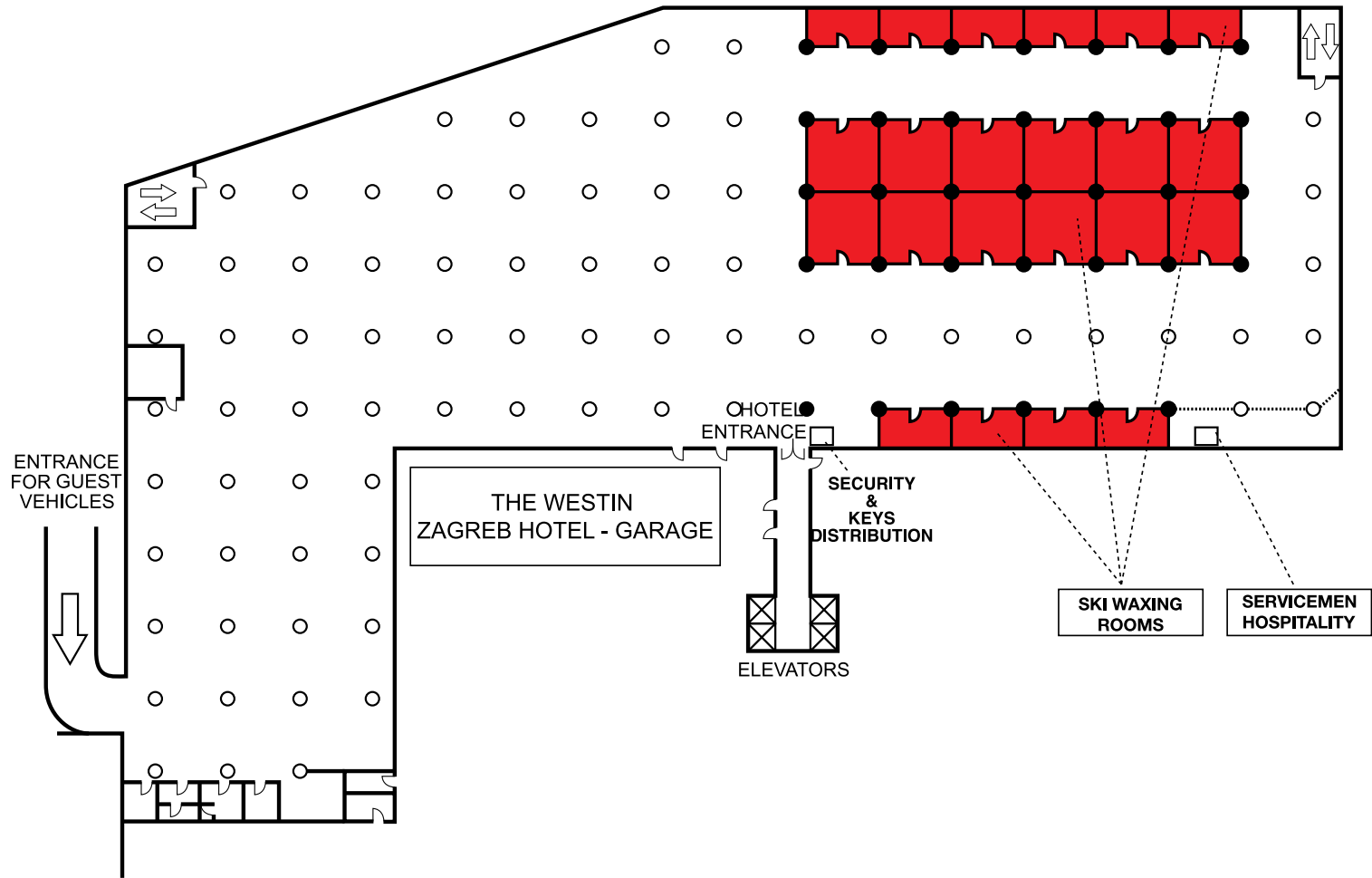

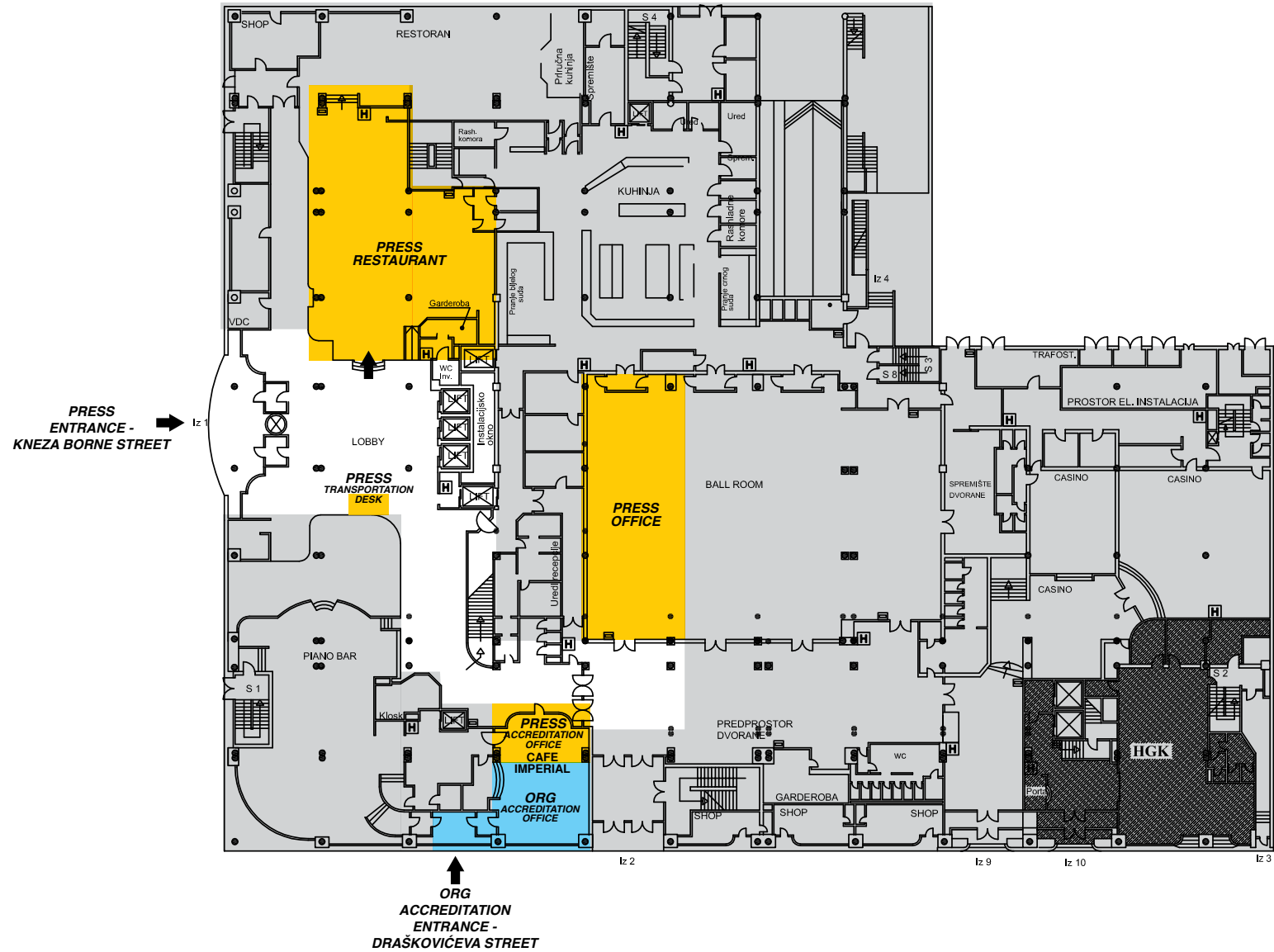

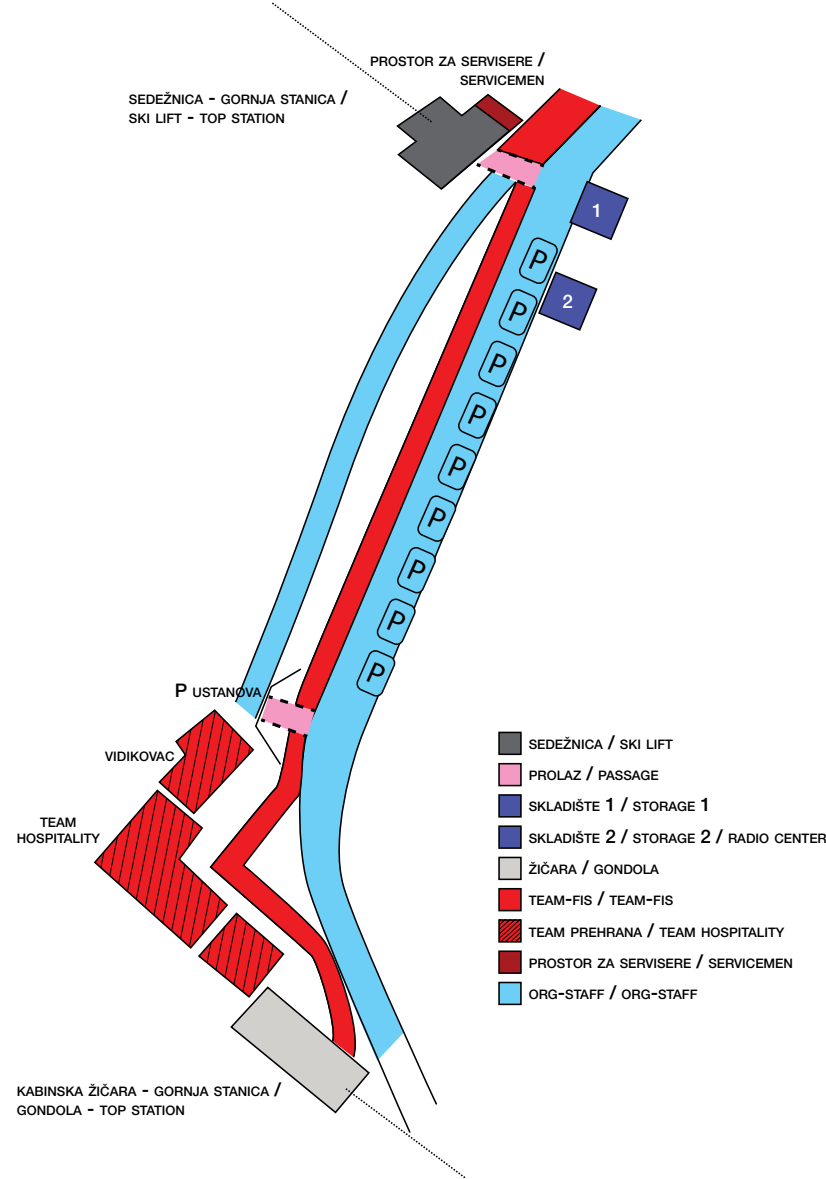



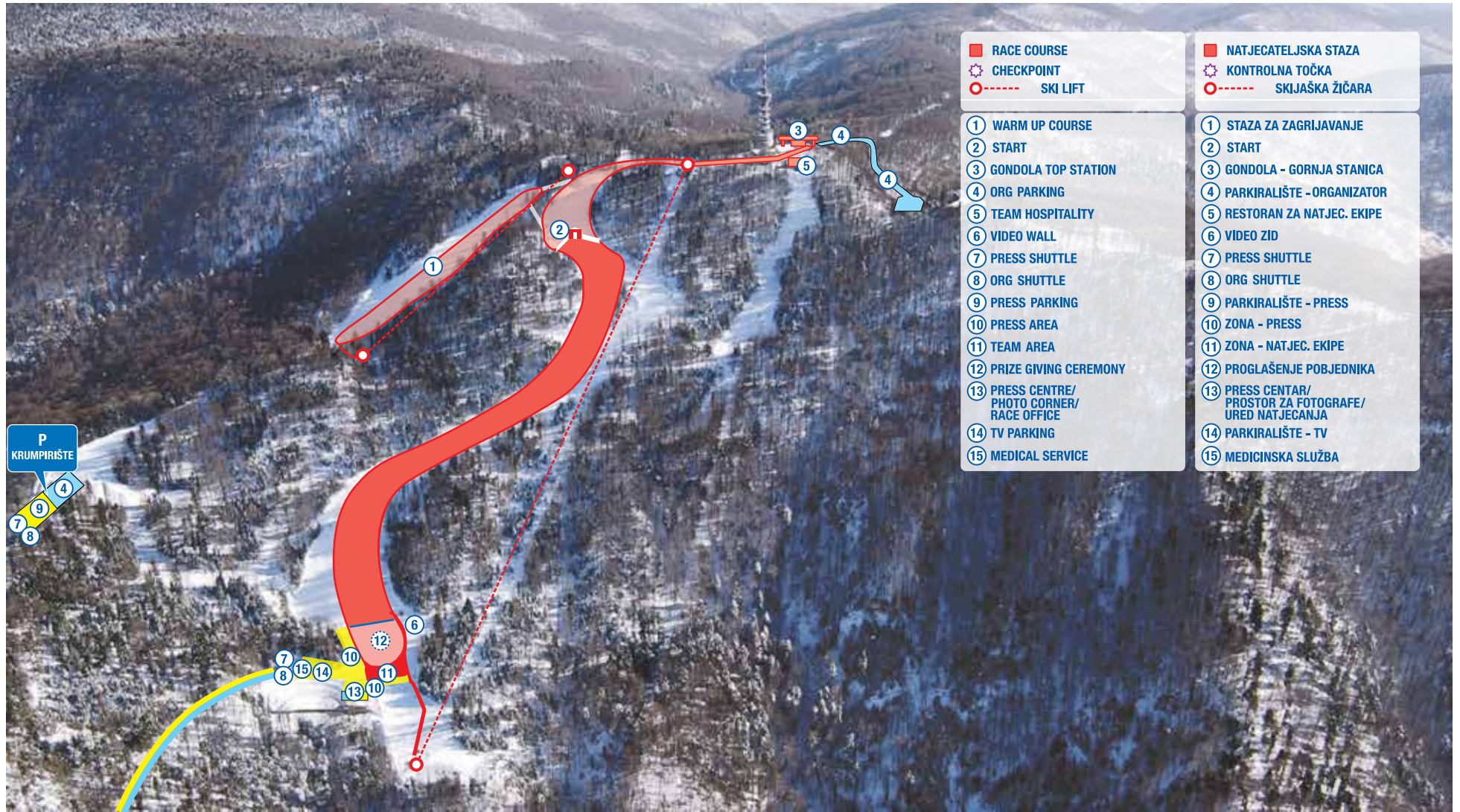

- 00 kontrolne točke / checkpoints
- 1 press i radio zona / press and radio zone
- 2 TV prostor / Live TV area
- 3 foto platforma / photo platform
- 4 komentatorske kabine / commentary boxes
- 5 parkiralište za TV kamione / TV truck parking
- 6 prostor za fotografe / photo corner
- 7 press centar / press centre
- 8 platforma za TV kameru / TV camera platform
- 9 ENG prostor / ENG area
- 10 prehrana - mediji / media hospitality
- 11 ulaz za TV - foto - novinare - organizatore / TV - photo - press - organiser entrance
- 12 ulaz na tribinu / stand entrance
- 13 prostor za vodećeg natjecatelja / leader area
- 14 kamera za vodećeg natjecatelja / leader camera
- 15 FIS šator za kontrolu skijaške opreme / FIS material control tent
- 16 zona za natjecateljske ekipe 1 / team 1 zone
- 17 zona za natjecateljske ekipe 2 / team 2 zone
- 18 šator za presvlačenje / changing tent
- 19 izlaz sa staze za natjecateljske ekipe / team exit from the race course
- 20 ulaz na žičaru za natjecateljske ekipe / ski lift team entrance
- 21 ulaz na žičaru za natjecateljske ekipe - pješaci / ski lift team entrance - pedestrians
- 22 izlaz sa žičare za natjecateljske ekipe - pješaci / ski lift team exit - pedestrians
- 23 ulaz mediji - organizator / media - organiser entrance
- 24 ured natjecanja / race office
- 25 ulaz na žičaru za organizatore - pješaci / ski lift organisers entrance - pedestrians
- 26 izlaz sa žičare za organizatore / ski lift organiser exit
- 27 izlaz sa staze za organizatore / organiser exit from the race course
- 28 ulaz na žičaru za organizatore / ski lift organiser entrance
- 29 prehrana - organizator / organiser hospitality
- 30 "zračna" zaštitna ograda / air fence
- 31 izlaz iz ciljne arene / finish arena exit gate
- 32 semafor za mjerenje vremena - mali / timing screen - small
- 33 reklame na napuhavanje / inflatables
- 34 kućica za mjerenje vremena / timing house
- 35 semafor za mjerenje vremena / timing screen
- 36 video zid / video wall
- 37 MUP - osiguranje / police - security
- 38 TV kablovi / TV cables
- 39 tribina / stand
- 40 prostor za medicinsko osoblje / medical team area
- 41 medicinska služba / medical service
- 42 TOI-TOI wc-i / TOI-TOI toilets
- 43 kućica s toplim napitcima / house with hot drinks
- 44 platforma za zvučnike / speakers platform
- 45 prostor za proglašenje pobjednika / awards ceremony area
- dvometarska zaštitna ograda / two-meter fence
- S osiguranje / security

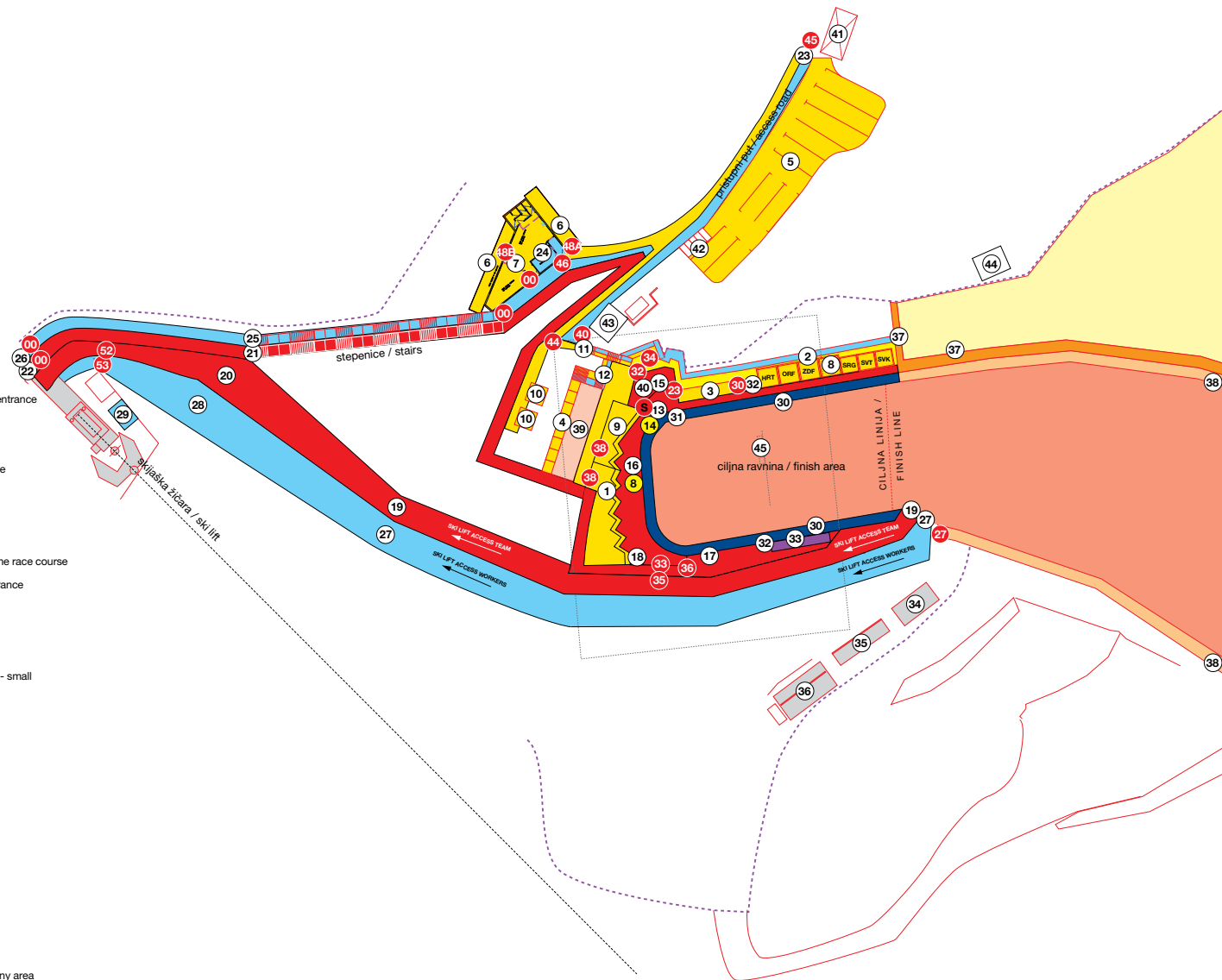

- 00 kontrolne točke / checkpoints
- 1 press i radio zona / press and radio zone
- 2 TV prostor / Live TV area
- 3 foto platforma / photo platform
- 4 komentatorske kabine / commentary boxes
- 8 platforma za TV kameru / TV camera platform
- 9 ENG prostor / ENG area
- 11 ulaz za TV - foto - novinare - organizatore / TV - photo - press - organiser entrance
- 12 ulaz na tribinu / stand entrance
- 13 prostor za vodećeg natjecatelja / leader area
- 14 kamera za vodećeg natjecatelja / leader camera
- 15 FIS šator za kontrolu skijaške opreme / FIS material control tent
- 16 zona za natjecateljske ekipe 1 / team 1 zone
- 17 zona za natjecateljske ekipe 2 / team 2 zone
- 18 šator za presvlačenje / changing tent
- 19 izlaz sa staze za natjecateljske ekipe / team exit from the race course
- 27 izlaz sa staze za organizatore / organiser exit from the race course
- 30 "zračna" zaštitna ograda / air fence
- 31 izlaz iz ciljine arene / finish arena exit gate
- 39 tribina / stand
- 32 semafor za mjerenje vremena - mali / timing screen - small
- 33 reklame na napuhavanje / inflatables
- 40 prostor za medicinsko osoblje / medical team area
- 45 prostor za proglašenje pobjednika / awards ceremony area
- - - - - dvometarska zaštitna ograda / two-meter fence
- S osiguranje / security

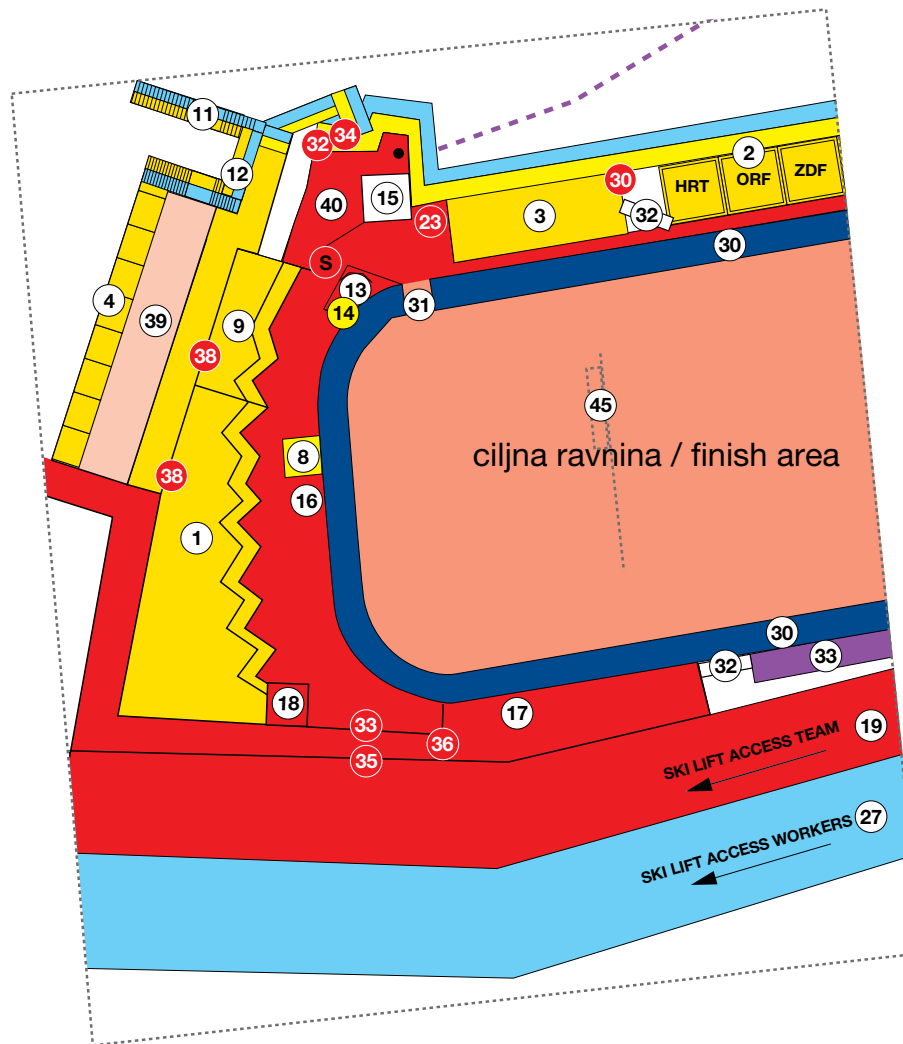

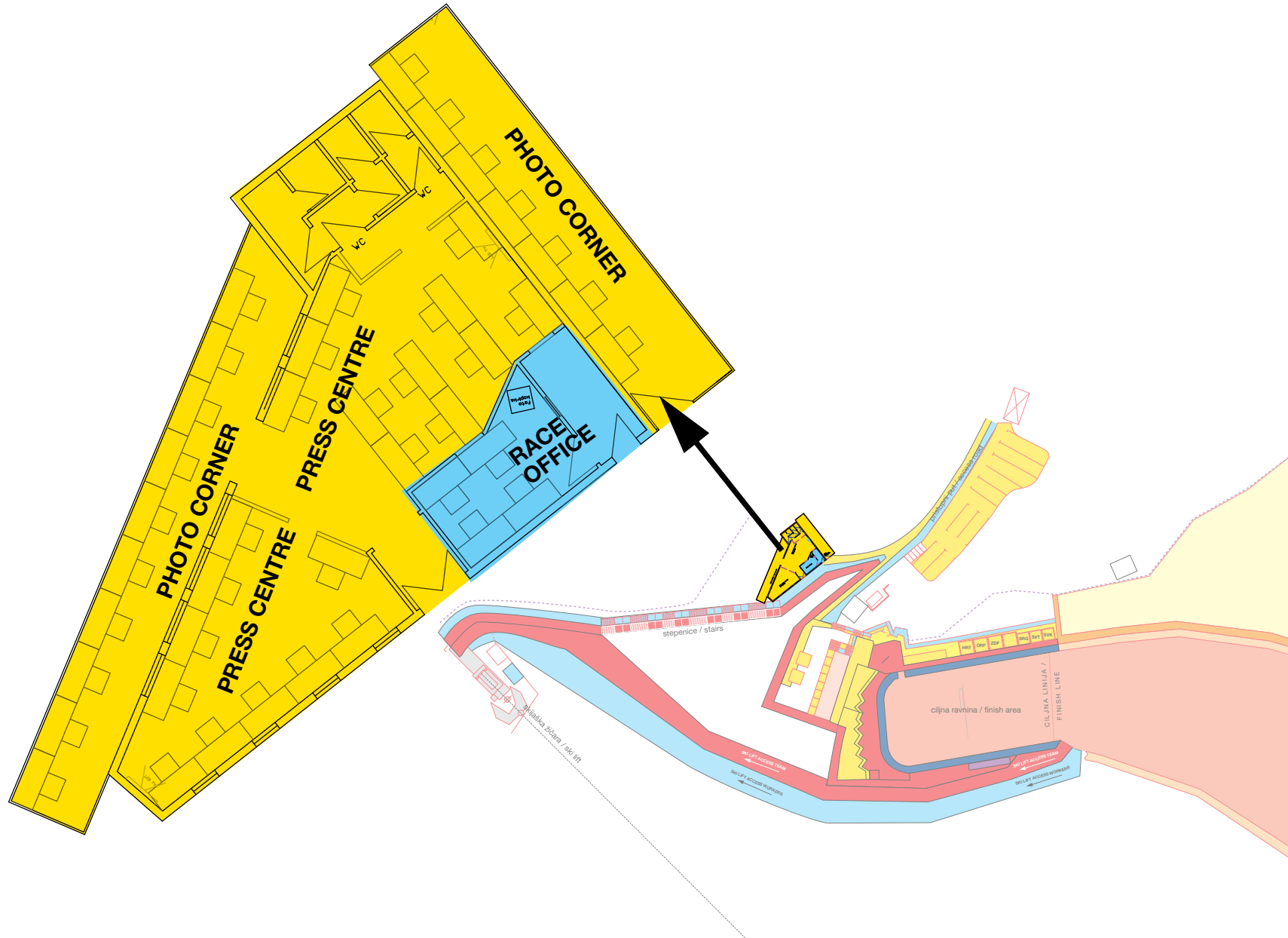

COVID-19 PREVENTION GUIDELINES AND TEST PROTOCOL

CROATIAN SKI ASSOCIATION

TRG KREŠIMIRA ČOSIĆA 11 | HR-10000 ZAGREB | TEL: +385-1-3093 009 | FAX: +385-1-3093 016

E-MAIL: INFO@SNOWQUEENTROPHY.COM | CROSKI@CROSKI.HR | WWW.SNOWQUEENTROPHY.COM | WWW.CROSKI.HR